



MYANMAR RIVER JOURNEYS

HANDBOOK OF SAILINGS & GENERAL INFORMATION

Travellers Edition

SEPTEMBER 2011 - APRIL 2012

(4TH EDITION AUG 2011)

Cruises operated with the Vessels

Rv PAUKAN
2 0 1 2
A Small Cruising Boutique Hotel

Rv PAUKAN
2 0 0 7
A Charming Cruising Boutique Hotel

Rv PAUKAN
1 9 4 7
An Original 1947 Built Colonial Steamer

COMPANY PROFILE COMPANY PROFILE

COMPANY NAME

We have chosen the name Ayravata because the Burmese name of Irrawaddy (also spelt Ayeyarwaddy from the Pali Eravati) is derived from the name in Sanskrit of the elephant mount of Indra, Airavati (or Ayravata). This Divine Elephant is thought of as the progenitor of all earthly elephants and is understood as the embodiment of the huge clouds pregnant with the monsoon rains. Elephants were in Indian mythology often a symbol for water

FLEET NAME

Rv Paukan comes after "Paukan Rarma", the city founded in the 846 AD by King Pyinbyaat to replace the former capital called Thanpawaddy. Paukan is the old name of Bagan.

THE STORY

Ayravata Cruises was founded in the 2003 by three Myanmar entrepreneurs with the support and management of a European expert in cruises on Asian rivers. Thanks to the vast experience of the founders in the Myanmar hospitality and tourism business coupled by the expertise of the foreign executive director, Ayravata Cruises is not just a successful cruise operator but a shipbuilder as well. The company has a total of 60 staff, 50 employed as crew on board the two ships and 10 in the offices of Yangon and Mandalay.

Presently it operates two ships: RV Paukan 2007 (a newly built Charming Cruising Boutique Hotel) and RV Paukan1947 (an original Scottish made Colonial Steamer formerly known as Rv Panfaw), a third ship RV Paukan2012 is now under construction and supposed to be completed in the 2012.

Our boutique cruises on the Irrawaddy and Chindwin Rivers will unveil you the Myanmar cultural heritage, the ex Royal capitals, the lifestyle and traditions of the people living along their banks.



MANAGED BY AYRAVATA CRUISE COMPANY

CONTENTS

THE FLEET	4
SHORT DISCOVERY CRUISES	10
BETWEEN MANDALAY & BAGAN CRUISES	10
Between Royal Mandalay and Ancient Bagan (1Night)	11
Between Ancient Bagan and Royal Mandalay (2 Nights)	12
From Royal Mandalay (Mingun & Sagaing) to Ancient Bagan (2 Nights)	13
IRRAWADDY DISCOVERY CRUISES	15
GOLDEN MYANMAR (10 Nights)	16
THE ROYAL CAPITALS (NEW)	21
“The Royal Capitals”- Bagan to Mandalay and beyond (5 Nights)	21
“The Royal Capitals” Mandalay and beyond to Bagan (5 Nights)	22
EXPLORATION CRUISES	30
Grand Voyage of the Chindwin River (9 Nights)	30
”Myanmar Days” – The Bhamo Cruise - (7 Nights)	30
SAILING DATES 2011-2012	37
Terms & Conditions	45
Passenger Ticket Contract	48



MANAGED BY AYRAVATA CRUISE COMPANY

THE FLEET

RV PAUKAN 2007

SPECIFICATIONS

BUILT IN YANGON 2007 BY AYRAVATA CRUISES AT MYANMA SHIPYARDS (YANGON-MYANMAR)

LENGTH	183 FT (55.78 MT)
BEAM	38 FT (11.58 MT)
DESIGN DRAFT	3.09 FT (1.14 MT)
DECKS	3
DIESEL ENGINES	2 x 425 HP CUMMINS MARINE / MODEL KT19-M425.
PROPULSION	SCHOTEL TYPE OUTBOARD * MODEL: NAV180
DESIGN SPEED	10 KNOTS
MAX. UPSTREAM SPEED	8 NAUTICAL MILES PER HOUR (DRY SEASON)
MAX. DOWNSTREAM SPEED	12 NAUTICAL MILES PER HOUR (DRY SEASON)
NAVIGATION	NAVIGATION LIGHTS, SHIPS HORN, SEARCHLIGHT
COMMS	GSM PHONE, INTERNAL PHONE SYSTEM, TANNOY FOR NAVIGATION
GENERATORS	2 x 175 KVA + 1 x 50 KVA CUMMINS/MARATHON MARINE
FIRE PROTECTION	SMOKE DETECTORS, HEAT DETECTORS, MANUAL ALARMS STATIONS, FIRE EXTINGUISHERS, FIRE HOSE CABINETS, FIRE PUMPS
SAFETY	EMERGENCY LIGHTS, EMERGENCY GENSET, LIFE JACKETS, LIFE RAFTS
CREW	30
<u>HOTEL</u>	
PASSENGERS	55
CABINS	29 WITH PRIVATE BATHROOM AND SHOWER
	<u>UPPER DECK</u>
	14 DELUXE (6 DOUBLE, 8 TWIN) * 21 SQ.MT/226 SQ. FT.
	2 SUITE (BOW) : 40 SQ.MT / 430 SQ. FT.
	<u>MAIN DECK</u>
	10 SUPERIOR TWINS * 15 SQ.MT./161 SQ. FT.
	<u>LOWER DECK</u>
	3 SINGLE FOR GUESTS: 10 SQ MT / 107 SQ. FT.
	4 SINGLE FOR GUIDES/TL: 8 SQ MT / 86 SQ. FT.
LOUNGE & BAR	ON THE SUNDECK/SOLARIUM (CAPACITY 35 SEATS)
DINING ROOM	ON THE MAIN DECK (CAPACITY: 56 SEATS)
MESSAGE ROOM	2 ON THE LOWER DECK
LECTURES ROOM	FULLY EQUIPPED WITH LCD PROJECTOR/LCD TV (35 SEATS)
WATER	DESEDIMENTATION AND FULL WATER TREATMENT – REVERSE OSMOSIS SYSTEM FOR THE KITCHEN



MANAGED BY AYRAVATA CRUISE COMPANY

ABOUT RV PAUKAN 2007

Paukan is the ancient name of Bagan, the old city of two thousand temples on the bank of the Irrawaddy River.

RV Paukan was built in 2007 at the Myanmar Shipyards in Yangon for Ayravata Cruises.

ON BOARD

The lovely Paukan is a boutique hotel on the river, beautifully furnished with a unique combination of modern and traditional motifs. The timber-walled cabins are furnished with colonial style cupboards, dresser and doors while the ceiling is traditional Myanmar. The single or double beds are proper and comfortable ones and not mere bunks, enough room for 55 passengers who will be looked after by a 30-member crew.

For luxury-living, Paukan has suites, deluxe or superior cabins as well as singles for guest or guides. There are two massage rooms on the lower deck offering traditional Myanmar massage designed to give soothing relaxation.

The sun deck has a stage for cultural performances, and a bar and lounge for relaxation and fun. The upper deck has a lecture / movie room with lcd projector and lcd TV screen.

Meals in the dining room on the main deck will include both East and West cuisine, and dinner menus of delicious dishes. Vegetarian meals can be prepared when informed in advance.



MANAGED BY AYRAVATA CRUISE COMPANY

Rv P A U K A N

2 0 0 7

A Charming Cruising Boutique Hotel

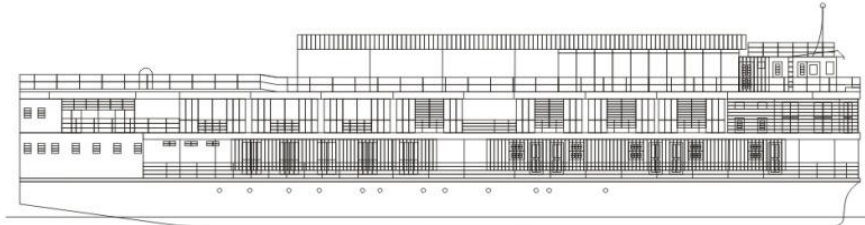

ELEVATION



SUN DECK PLAN

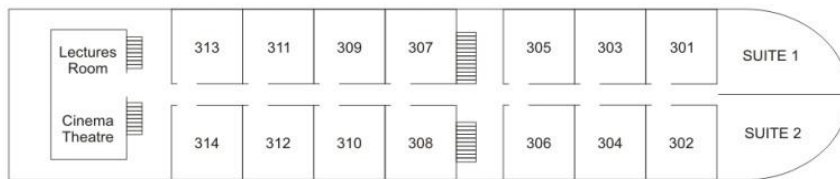

UPPER DECK PLAN

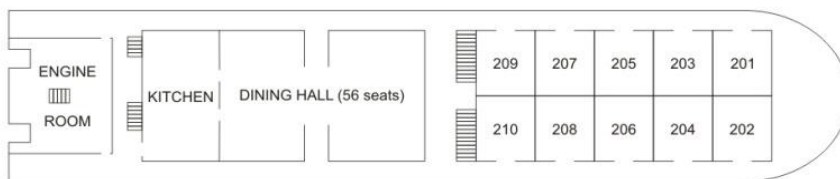

MAIN DECK PLAN

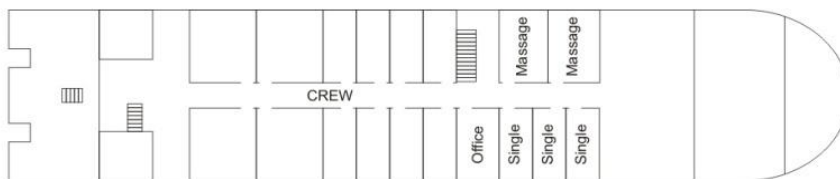

LOWER DECK PLAN



MANAGED BY AYRAVATA CRUISE COMPANY

NEW!

RV PAUKAN 2012

SPECIFICATIONS

UNDER CONSTRUCTION BY AYRAVATA CRUISES AT AHLONE SHIPYARD (YANGON) – TO BE COMPLETED IN MID-2012

HULL	MARINE STEEL
LENGTH	138 FT (42 MT)
BEAM	32.8 FT (10 MT)
DESIGN DRAFT	2.5 FT (0.76 MT)
DECKS	3
DIESEL ENGINES	2 X 275 HP CUMMINS MARINE / MODEL NT855-M270
PROPULSION	RUDDER PROPELLER INBOARD WELL MOUNTED
DESIGN SPEED	10 KNOTS
MAX. UPSTREAM SPEED	8 NAUTICAL MILES PER HOUR (DRY SEASON)
MAX. DOWNSTREAM SPEED	12 NAUTICAL MILES PER HOUR (DRY SEASON)
NAVIGATION	NAVIGATION LIGHTS, SHIPS HORN, SEARCHLIGHT
COMMS	GSM PHONE, INTERNAL PHONE SYSTEM, TANNOY FOR NAVIGATION
GENERATORS	2 X 120 KVA + 1 X 40 KVA CUMMINS/MARATHON MARINE
FIRE PROTECTION	SMOKE DETECTORS, HEAT DETECTORS, MANUAL ALARMS STATIONS, FIRE EXTINGUISHERS, FIRE HOSE CABINETS, FIRE PUMPS
SAFETY	EMERGENCY LIGHTS, EMERGENCY GENSET, LIFE JACKETS, LIFE RAFTS
CREW	20
<u>HOTEL</u>	
PASSENGERS	32
CABINS	17 WITH PRIVATE BATHROOM
	<u>UPPER DECK</u>
	6 DOUBLE DELUXE WITH BALCONY * 22 SQ.MT/ 236 SQ. FT.
	1 SUITE (BOW) : 40 SQ.MT / 430 SQ. FT.
	2 SINGLE DELUXE : 10 SQ.MT / 107 SQ. FT.
	<u>MAIN DECK</u>
	8 TWIN DELUXE WITH FRENCH BALCONY * 21 SQ.MT./226 SQ. FT.
	<u>LOWER DECK</u>
	2 SINGLE FOR GUIDES/TL: 8 SQ MT / 86 SQ. FT.
DINING ROOM	ON THE MAIN DECK (CAPACITY: 34 SEATS)
LOUNGE & BAR	ON THE UPPER DECK (CAPACITY 16 SEATS INDOOR AND 15 OUTDOOR)
SOLARIUM	ON SUN / ROOF DECK (CAPACITY: 16 SUN CHAIRS)
WATER	DESEDIMENTATION AND FULL WATER TREATMENT – REVERSE OSMOSIS SYSTEM FOR THE KITCHEN



MANAGED BY AYRAVATA CRUISE COMPANY

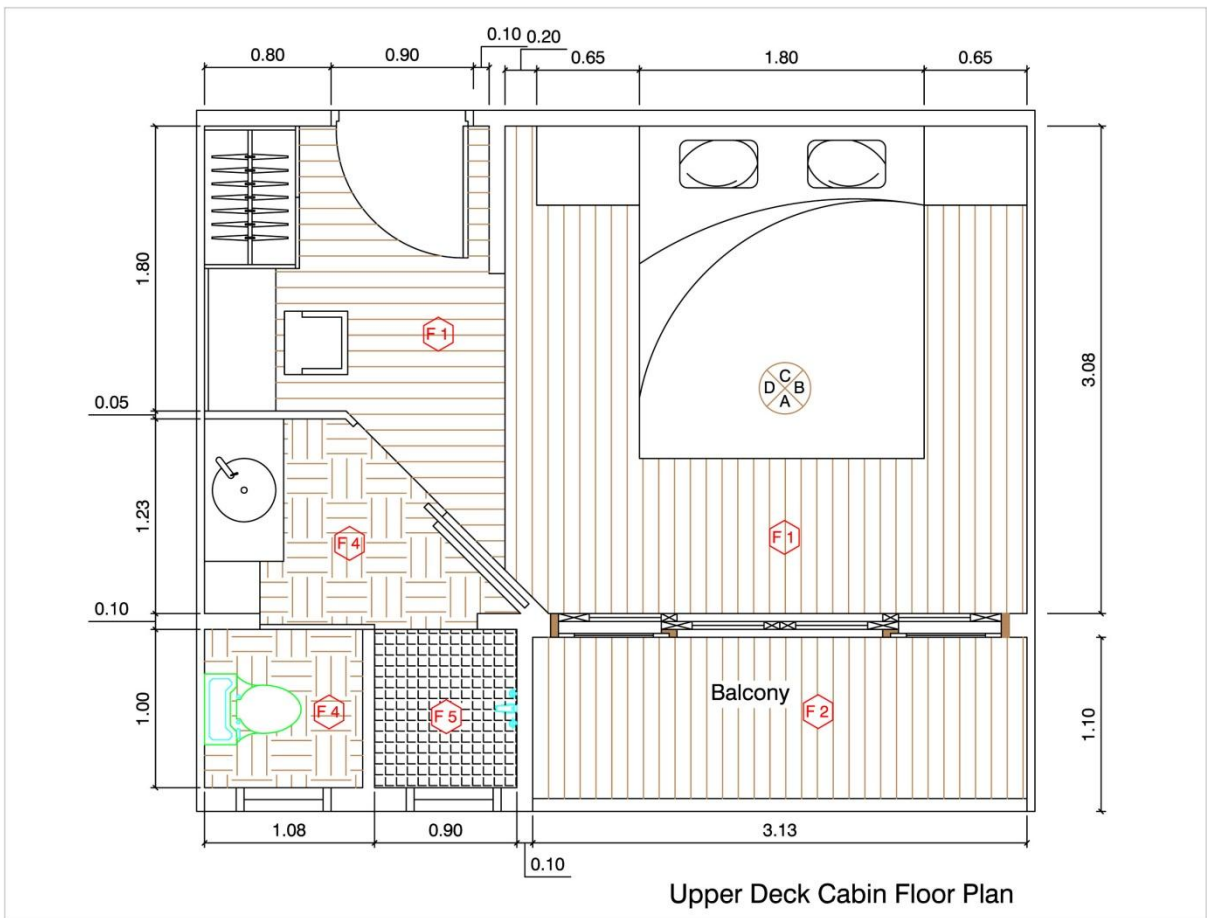
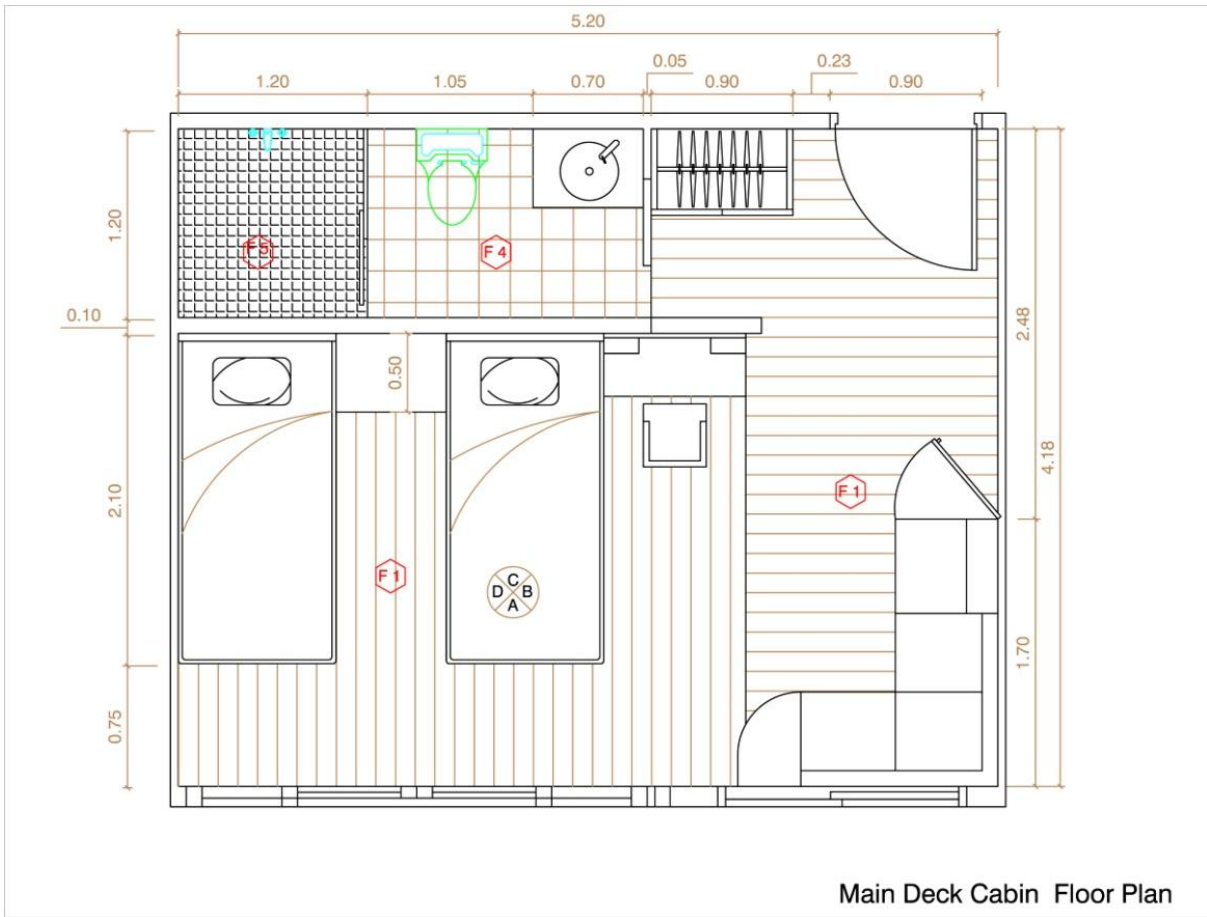

MANAGED BY AYRAVATA CRUISE COMPANY



RV PAUKAN
 2 0 1 2
 A Small Cruising Boutique Hotel

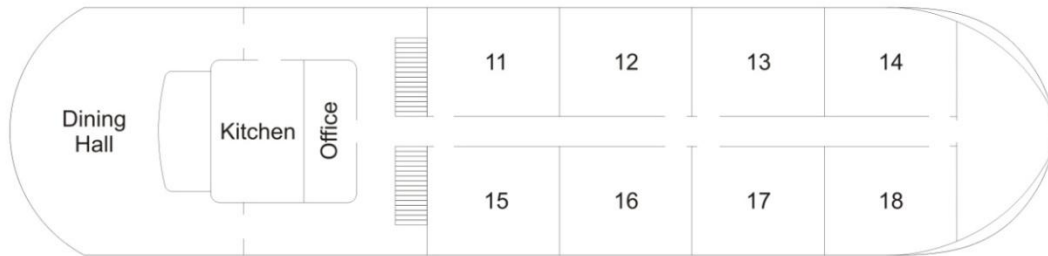

Elevation

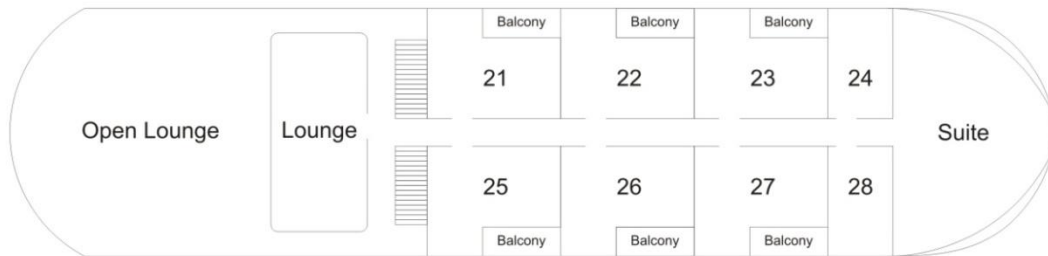

Main Deck



Upper Deck

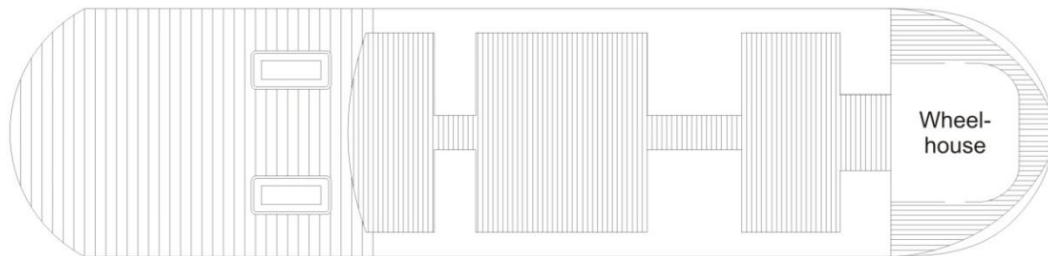

Sun Deck

RV PAUKAN 1947 (FORMERLY RV PANDAW 1947)

SPECIFICATIONS

BUILT IN SCOTLAND 1947 (BY YARROW & CO. SCOTLAND), CONVERTED TO A PASSENGER CRUISE VESSEL 1997 BY IRRAWADDY FLOTILLA CO. REFITTED AND REFURBISHED 2003-04 BY IWT (INLAND WATER TRANSPORT) & AYRAVATA CRUISES

HULL	STEEL
LENGTH	150FT (45.72 MT)
BEAM	34FT (11.5 MT)
DRAFT	2.6FT (0.8 MT)
DECKS	3 MAIN DECK (6 CABINS)* UPPER DECK (10 CABINS-SALOON-DINING ROOM) * SUNDECK / SOLARIUM (LENGTH 20 MT - FURNISHED WITH STEAMER CHAIRS/SUN LOUNGES/ RATTAN ARMCHAIRS FOR 32 PAX)
DIESEL ENGINES	2 x 300HP MWM * MODEL: TBD-234V6
PROPULSION	SCHOTEL OUTBOARD * MODEL: SRP-100/110
MAX. UPSTREAM SPEED	6 MILES PER HOUR
MAX. DOWNSTREAM SPEED	11 MILES PER HOUR
NAVIGATION	NAVIGATION LIGHTS, SHIPS HORN, SEARCHLIGHT
COMMS	GSM PHONE, INTERNAL PHONE SYSTEM, TANNOY FOR NAVIGATION
GENERATORS	2 x 95 KVA DENYO GENSETS
FIRE PROTECTION	21 SMOKE DETECTORS, 4 HEAT DETECTORS, 8 MANUAL ALARMS STATIONS, ELECTRONIC CONTROL PANEL <i>SILENT KNIGHT (MADE IN USA)</i> – 20 FIRE EXTINGUISHERS – 8 FIRE HOSE CABINETS, FIRE PUMP
SAFETY	EMERGENCY LIGHTS, EMERGENCY GENERATOR, LIFE JACKETS FOR ALL ON BOARD AND LIFE RAFTS
<u>HOTEL</u>	
CABINS	16 DELUXE CABINS WITH OWN SHOWER/WC (BERTHS 32) SIZE: 3,35 MT X 4.00 MT (132" X 158")
BAR	1
DINING ROOM	1 (32 SEATS)
KITCHEN	1 FULLY EQUIPPED KITCHEN
WATER	DESEDIMENTATION AND FULL WATER TREATMENT – REVERSE OSMOSIS SYSTEM FOR THE KITCHEN.
SEWAGE	TREATMENT PLANT



MANAGED BY AYRAVATA CRUISE COMPANY

ABOUT PAUKAN1947 (FORMERLY RV PANDAW1947)

HISTORY

The Pandaw (as it was originally named) is an original colonial era twin screw steamer, built in 1947. The famous shipbuilding company of Yarrow & Co. of Clyde on the River in Glasgow built the Pandaw for the Irrawaddy Flotilla Company. Arriving in Myanmar in 1950, under the ownership of the Inland Water Transport Board (IWTB) she ran on the Irrawaddy River from Mandalay to Bhamo, one of the most popular routes on this great river.

She began a luxury life as a passenger cruiser in 1998, under the management of a new Irrawaddy Flotilla Company and was taken over in 2003 by Ayravata Cruises after extensive renovations and refurbishing. The vessel was renamed Rv Paukan1947 in the 2011

ON BOARD

There are altogether 16 teak-walled deluxe cabins with proper beds and hot and cold showers. There is one main deck with cabins, an upper deck with cabins and a dining room at the stern and a salon at the prow.



MANAGED BY AYRAVATA CRUISE COMPANY

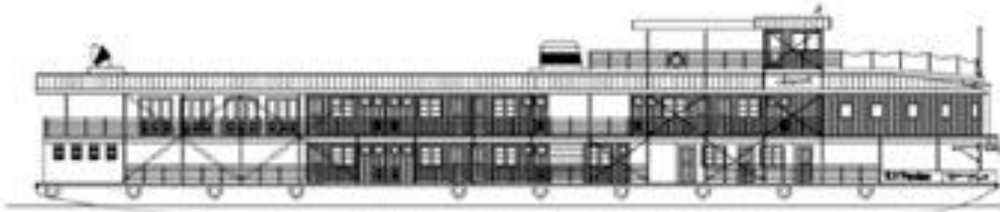

R V P A N D A W
 1 9 4 7
 An original 1947-built Colonial Steamer

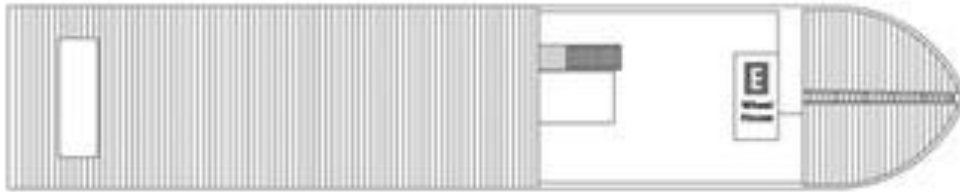

ELEVATION

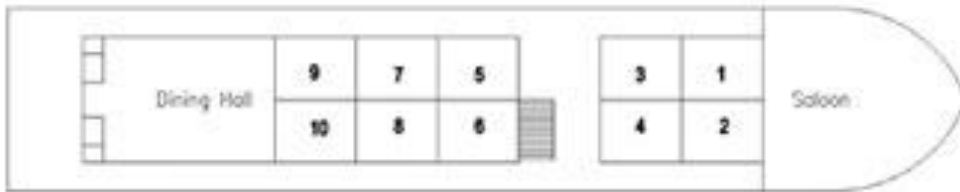

SUN DECK



UPPER DECK

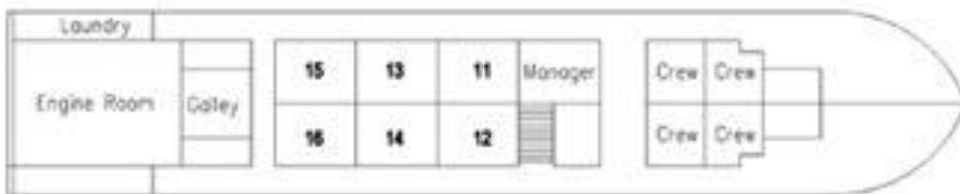

MAIN DECK

SHORT DISCOVERY CRUISES

BETWEEN MANDALAY & BAGAN

Cruises to discover the life of the mighty Irrawaddy between Bagan and Mandalay

All cruises Sorted by Duration

ONE NIGHT CRUISE

BETWEEN ROYAL MANDALAY AND ANCIENT BAGAN

(DOWNSTREAM: MANDALAY TO BAGAN)

DEPARTURE: THURSDAY* VESSEL: RV PAUKAN 2007

TWO NIGHT CRUISES

BETWEEN ANCIENT BAGAN AND ROYAL MANDALAY

(UPSTREAM: BAGAN TO MANDALAY)

DEPARTURE: TUESDAY & FRIDAY* VESSEL: RV PAUKAN 2007

FROM ROYAL MANDALAY (MINGUN & SAGAING) TO ANCIENT BAGAN

(DOWNSTREAM: MANDALAY – MINGUN – SAGAING – RIVER VILLAGE - BAGAN)

DEPARTURE: SUNDAY* VESSEL: RV PAUKAN 2007

All cruises Sorted by Departure Day

TUESDAY

BETWEEN ANCIENT BAGAN AND ROYAL MANDALAY

(UPSTREAM: BAGAN TO MANDALAY)

DURATION: 2 NIGHTS* VESSEL: RV PAUKAN 2007

THURSDAY

BETWEEN ROYAL MANDALAY AND ANCIENT BAGAN

(DOWNSTREAM: MANDALAY TO BAGAN)

DURATION: 1 NIGHT* VESSEL: RV PAUKAN 2007

FRIDAY

BETWEEN ANCIENT BAGAN AND ROYAL MANDALAY

(UPSTREAM: BAGAN TO MANDALAY)

DURATION: 2 NIGHTS* VESSEL: RV PAUKAN 2007

SUNDAY

FROM ROYAL MANDALAY (MINGUN & SAGAING) TO ANCIENT BAGAN

(DOWNSTREAM: MANDALAY – MINGUN – SAGAING – RIVER VILLAGE - BAGAN)

DURATION: 2 NIGHTS* VESSEL: RV PAUKAN 2007

MYANMAR TOURS + SHORT CRUISE PACKAGES

WE HAVE PREPARED A CHOICE OF TOURS OF MYANMAR INCLUDING A SHORT DISCOVERY CRUISE.

DETAILED PROGRAMS AND RATES CAN BE FOUND IN OUR "LAND TOURS" PUBLICATION.

IF YOU WISH TO RECEIVE A COPY CONTACT US OR DOWNLOAD FROM OUR WEBSITE.



MANAGED BY AYRAVATA CRUISE COMPANY

BETWEEN ROYAL MANDALAY AND ANCIENT BAGAN

(DOWNSTREAM: MANDALAY TO BAGAN)

Departure: Thursday * Duration: 1 night

THURSDAY

MANDALAY (SAGAING) – CRUISING TO BAGAN

Check-in Time

The embarkation time is at 10.00 hrs at SAGAING jetty. Welcome Cocktail in the Saloon.

Downstream to Bagan

The cast off time is at 10.30 hrs. Lunch will be served at 13.00. Cruise all day. In the late afternoon we stop at Yandabo, a village specialize in Pot-Making, where the peace treaty of the First Anglo-Burmese war was signed on Feb. 24, 1826. Moor overnight near the village of Shwe Nann Tint.

FRIDAY

BAGAN

River Village

Early in the morning we proceed Downstream to Bagan. After breakfast (if time permits) we visit another typical river village.

Check-Out Time

Enjoy the sunrise near Bagan. Passengers disembark at Bagan Aye Yar jetty by 9:30 hrs.



MANAGED BY AYRAVATA CRUISE COMPANY

BETWEEN ANCIENT BAGAN AND ROYAL MANDALAY

(UPSTREAM: BAGAN TO MANDALAY)

Departure: Tuesday & Friday * Duration: 2 Nights

TUESDAY / FRIDAY

BAGAN – CRUISING TO MANDALAY (STOP IN A RIVER VILLAGE)

Check-in Time

The embarkation is 11.30 hrs at Bagan Aye Yar jetty. Welcome Cocktail in the Saloon.

Upstream to Mandalay

The Cast off time is at 12 noon. Lunch will be served at 13.00.

In the late afternoon stop in a typical river village.

WEDNESDAY / SATURDAY

CRUISING TO MANDALAY (VISIT RIVER VILLAGE)

Upstream to Mandalay

Cruise all day with stop enroute in the morning to visit Yandabo, a typical river village specialize in Pot-Making, where the peace treaty of the First Anglo-Burmese war was signed on Feb. 24, 1826.

Moor overnight nearby a village (Ywar Thit Gyi or Pauk Myaing Pauk Taw) few miles away from Ava Bridge.

THURSDAY / SUNDAY

*MANDALAY (SAGAING *THU* – GAWEIN *SUN*)*

Check-Out Time

Enjoy the sunrise. After an early breakfast, the passengers will disembark at Sagaing Jetty (Thursday only) or Gawein jetty (Sunday Only) at around 09.30 hrs.



MANAGED BY AYRAVATA CRUISE COMPANY

FROM ROYAL MANDALAY (MINGUN & SAGAING) TO ANCIENT BAGAN
(MANDALAY – MINGUN – SAGAING – RIVER VILLAGE – BAGAN)

Departure: Sunday * Duration: 2 nights

SUNDAY

MANDALAY (GAWEIN) – MINGUN

Check-in Time

The embarkation time is at 12 noon at Gawein jetty. Welcome Cocktail in the Saloon.

Upstream to Mingun

Cast off time is at 12:30 hrs. Lunch will be served at 13.00. The sailing time is about 2 hrs. Our English speaking manager (or your private guide) will assist the guests during the visit of the Mingun Pagoda Complex.

Moor Overnight at a sandbank mid-stream. After dinner guests can enjoy a Dance and Drama performance by the Mandalay Arts School on the sundeck (if available).

MONDAY

MINGUN – SAGAING – RIVER VILLAGE

Downstream to Sagaing

Early in the morning cruise downstream. During the 2 hours journey the passengers can admire the natural beauty of the river and the life of its banks while relaxing on the sundeck or just sitting outside their own cabin. Enjoy the sunrise over Sagaing Hill

Visit Sagaing

After breakfast passengers can go ashore to visit Sagaing with the assistance of our Ship Manager or their own guide.

Downstream to Bagan

The cast off time is at 10.30 hrs. Lunch will be served at 13.00. In the late afternoon we stop at Yand-abo, a village specialize in Pot-Making, where the peace treaty of the First Anglo-Burmese war was signed on Feb. 24, 1826. Cruise all day and moor overnight near a river village.

Moor overnight near the village of Shwe Nann Tint.

TUESDAY

BAGAN

River Village

Early in the morning we proceed Downstream to Bagan. After breakfast (if time permits) we visit another typical river village.

Check-Out Time

Enjoy the sunrise near Bagan. Passengers will disembark at Aye Yar jetty around 9:30 hrs.



MANAGED BY AYRAVATA CRUISE COMPANY

RETAIL RATES

PER PERSON IN US\$ VALID FROM 16 OCTOBER 2011 TO 01 MAY 2012

HIGH SEASON (16 OCT 11–03 APR 12)

Between Royal Mandalay and Ancient Bagan * (1N Downstream / Dep. Thu)

Main Deck	Twin Cabin US\$310	Twin Cabin Single use US\$465
Upper Deck	Twin/DbI Cabin US\$375	Twin/DbI Cabin Single use: US\$565
	Suite Bow: US\$700	Suite Bow single use: US\$1,400
Lower Deck	Single: US\$270	

From Royal Mandalay (Mingun & Sagaing) to Ancient Bagan * (2N Downstream / Dep. Sun)

Between Ancient Bagan and Royal Mandalay * (2N Upstream / Dep. Tue, Fri)

Main Deck	Twin Cabin US\$620	Twin Cabin Single use US\$930
Upper Deck	Twin/DbI Cabin US\$750	Twin/DbI Cabin Single use: US\$1,130
	Suite Bow: US\$1,400	Suite Bow single use: US\$2,800
Lower Deck	Single: US\$540	

NEW YEAR'S EVE 2N CRUISE (30 DECEMBER 2011): RATES & DETAILED PROGRAM TBA

SHOULDER SEASON (04 APR 12 - 01 MAY 12)

Between Royal Mandalay and Ancient Bagan * (1N Downstream / Dep. Thu)

Main Deck	Twin Cabin US\$280	Twin Cabin Single use US\$420
Upper Deck	Twin/DbI Cabin US\$340	Twin/DbI Cabin single use: US\$505
	Suite Bow: US\$630	Suite Bow single use: US\$1,260
Lower Deck	Single: US\$220	

From Royal Mandalay (Mingun & Sagaing) to Ancient Bagan * (2N Downstream / Dep. Sun)

Between Ancient Bagan and Royal Mandalay * (2N Upstream / Dep. Tue, Fri)

Main Deck	Twin Cabin US\$560	Twin Cabin Single use US\$840
Upper Deck	Twin/DbI Cabin US\$675	Twin/DbI Cabin single use: US\$1,020
	Suite Bow: US\$1,260	Suite Bow single use: US\$2,520
Lower Deck	Single: US\$485	

CRUISE RATE INCLUDES

All Cruises: Full Board, Sightseeing in a river village, Coffee / Tea / Water

Sunday Dep. 2Nights Cruise Shore Excursions: Vehicle in Sagaing + Entrance fees for Mingun / Sagaing + Dance and Drama show on the sundeck.

CRUISE RATE EXCLUDES

Transfer to the ship from Mandalay / Bagan Airport or Hotel, drinks, laundry, all items of a personal nature; Insurance outside the ship boundaries, fuel surcharges if applicable.

IMPORTANT NOTE: For All the departures should the occupancy be less than 10 PASSENGERS the Company reserves the right to cancel the cruise up to 30 days prior the departure date. A written confirmation notice will be released to all booked clients and/or their agents within and not later than 30 days prior the departure date. In case of cancellation an alternative cruise will be offered and if not acceptable all down payments will be re-funded.



MANAGED BY AYRAVATA CRUISE COMPANY

IRRAWADDY DISCOVERY CRUISES

.....AND SEE ALL MYANMAR

GOLDEN MYANMAR & ROYAL CAPITALS CRUISES

The Irrawaddy River has witnessed the history of Myanmar and gave it life. On its banks are located all the “must see” highlights of the Golden Land from the city of Pyay (Prome), where the roots of the Bamar civilization can be found, to the Royal Capitals of Mandalay, Amarapura and Ava passing through the glorious city of Bagan with its 3,000 temples and pagodas where sat the First Myanmar Empire.

There is no better way to visit all Myanmar than taking a “boutique” cruise on the Irrawaddy in the comfort of our original 1947-built luxury steamer.

No more long coach trips and the hassle to pack and unpack luggage.

Our comprehensive cruise programs include also all pre/post land arrangements in Yangon where we have chosen the historic Strand Hotel as it better matches with the concept of our colonial steamer.

To complete the visit of Myanmar we offer an optional extension to Inle Lake which is not to be missed.

GOLDEN MYANMAR

10 nights

UPSTREAM: YANGON – PROME – THAYETMYO – MINHLA – MAGWE – SALAY - BAGAN – RIVER VILLAGE - AVA-MANDALAY- AMARAPURA- KYAUK MYAUNG - MINGUN-SAGAING

DOWNSTREAM: MANDALAY - KYAUK MYAUNG – MINGUN – SAGAING – AMARAPURA - AVA – RIVER VILLAGE - BAGAN – SALAY- MAGWE – THAYETMYO – PROME - YANGON

THE “NEW” ROYAL CAPITALS

5 nights

UPSTREAM: YANGON - BAGAN - RIVER VILLAGE - AVA-MANDALAY-AMARAPURA- KYAUK MYAUNG - MINGUN-SAGAING

DOWNSTREAM: MANDALAY - KYAUK MYAUNG – MINGUN – SAGAING – AMARAPURA - AVA – RIVER VILLAGE - BAGAN

PRE/POST CRUISE LAND TOURS

YANGON STOPOVER PACKAGE

A stopover before and after the cruise in the ex capital of Myanmar including the visit of Shwedagon Pagoda, Colonial Downtown and the famous Scott’s Market.

DURATION: 1+2 Days/1+1 night

INLE LAKE EXTENSION PACKAGE

A tour of Myanmar is not complete without visiting Inle Lake in the Shan State. Tour includes a full day boat excursion and half day to the 16th century pagoda complex of Indein.

DURATION: 2 Days/1 night



MANAGED BY AYRAVATA CRUISE COMPANY

GOLDEN MYANMAR

BETWEEN PROME AND BEYOND MANDALAY

10 nights cruise on original PANDAW (1947) & 2 nights at a Yangon hotel

UPSTREAM

DAY 1

RANGOON/YANGON – PROME/PYAY – THAYETMYO (40 MILES *65 KM – 8 HRS)

Drive to **Prome** by coach and board Pandaw 1947. Once controlled by the Mon during the Bagan Era and then conquered by the Burmese King Alaungpaya in the 1754, this quiet town boomed along with the Irrawaddy Flotilla Company in the 1890's and it is now an important trading post. In the afternoon we drive to **Thayekhittaya** (also known as Sri Ksetra, the "Fabulous city" in Pali language), an ancient Pyu city that ruled in this area between the 5th and the 9th century AD. In central Prome if time permits we visit the impressive **Shwesandaw Pagoda complex**, one of the most important Buddhist pilgrimage site of Myanmar, and the **Wunchataung Paya** (Apology Mountain Pagoda) a vantage point of the Shwesandaw Pagoda and the surrounding mountains.

DAY 2

THAYETMYO – MINHLA (56 MILES * 90 KM – 11 HRS)

Early Morning exploration of **Thayetmyo**: the oldest golf course of Myanmar, the market and the old colonial houses. Proceed cruising upstream. Moor overnight off Minhla.

DAY 3

MINHLA – MAGWE (19 MILES * 30 KM)

In the morning we reach **Minhla** and **Gwechaung** by local boat. Visit the two forts built by two Italian Military Engineers for the Burmese King in order to keep the British at bay from Royal Myanmar at the time of the 2nd Anglo-Burmese War. Arrive **Magwe** in the afternoon. Visit **Myat Than Lun Paya**, a 1929 built pagoda of gold solid bricks set on a hilltop with a beautiful view of the river. If time permits we drive to **Minbu** a small village across the river where we explore the Nga Ka Pwe Taung (Dragon Lake), a burping pond of Butane Gas set in a moon-like plot of land with bubbling pools.

DAY 4

MAGWE - SALAY (61 MILES *98 KM – 11 HRS)

Visit the **Magwe** picturesque market by trishaw. Sail all day upstream.

DAY 5

SALAY – TAN KYI (22 MILES *35 KM – 5 HRS)

Visit **Salay**, a village founded in the 13th century with Bagan-era shrines, beautiful 19th century teak monasteries and preserved British colonial buildings. Continue Upstream to the village of **Tan Kyi**. Reach the mountaintop by WW2 jeep where stands one of the four stupas that marked the original edges of the city and enjoy a marvelous sunset over Bagan plain.

DAY 6

BAGAN

We visit a selection of the 2,000 listed pagodas and temples and lacquerware shops in **Bagan**.

DAY 7

BAGAN – YANDABO (MILES 60*KM 111 – 12 HRS)

Cast off time at 10.30 hrs. We cruise upstream all day. Stop at **Shwe Pyi Thar** village for a walk.



MANAGED BY AYRAVATA CRUISE COMPANY

In the early evening we arrive at **Yandabo**, a picturesque village that specializes in Pot-Making, where the peace treaty of the First Anglo-Burmese war signed on Feb. 24, 1826. Dinner followed by a Puppet Show performance in the village or sundeck.

DAY 8

*YANDABO – AVA/INWA (MILES 58*KM 107 – 12 HRS)*

Early Morning we go ashore for a walk through the village stopping to some pot-making workshops to learn their unique production technique, the school and the monastery. Back to the ship for breakfast and cast off (ETD 09.00 hrs). We continue upstream to the ancient city of **Ava**, capital of the Burmese Kingdom from 1364 to 1841.

DAY 9

*AVA - MANDALAY AMARAPURA - KYAUK MYAUNG (MILES 45*KM 83 – 9 HRS)*

We explore **Ava** by horse-cart visiting the beautiful 200 year old teak **Bagaya Kyaung Monastery**, **Nanmyin watchtower** (27mt. high) and the **Me Nu Ok Kyaung monastery**. We travel by sampan and coach to **Amarapura**, the penultimate Burmese Royal Capital (1783) to visit **U-Bein Bridge** followed by central **Mandalay** visiting **Mahamuni Pagoda**, a **Gold leaf making workshop** and if time permits Mandalay Hill. Back to the ship for lunch and proceed upstream (ETD 13:30/14:00). Moor overnight nearby a river village North of Mandalay.

DAY 10

*KYAUK MYAUNG - MINGUN – SAGAING (MILES 54*KM 100 – 5 HRS)*

Visit the spectacular **potteries-making village of Kyauk Myaung**, and see the manufacture stages of the famous **50 Gallons (200 Litres) pots** (1.5 hours visit). Cruise downstream to **Mingun** where we visited the unfinished pagoda, the largest working bell in the world and the “home for the aged”. Moor overnight at Sagaing. Dance and Theatre performance on the Sundeck.

DAY 11

SAGAING (DISEMBARK) – YANGON

Disembark at Sagaing.

PRE AND POST UPSTREAM CRUISE TOUR

TOUR CODE GMU_PP1.2

YANGON STOPOVER

Duration: 2 nights / 3 Days

DAY 1 BEFORE THE CRUISE

RANGOON (YANGON)

International arrival to Yangon, transfer to the Hotel. Lunch in the hotel. In the afternoon orientation tour of the city ending with the visit of the most enchanting and spectacular Pagoda of Myanmar: **the Shwedagon**. Overnight at the historic **Strand Hotel** or Chatrium. Dinner at a local restaurant.

DAY 1 AFTER THE CRUISE

SAGAING (DISEMBARK) – YANGON

Disembark at Sagaing. Transfer to the Airport flight to Yangon. Check in at the Strand Hotel or Chatrium. Afternoon visit **Sule Paya** and **Colonial downtown**. Dinner at the hotel.

DAY 2 AFTER THE CRUISE

YANGON - DEPARTURE



MANAGED BY AYRAVATA CRUISE COMPANY

International departures.



MANAGED BY AYRAVATA CRUISE COMPANY

DOWNSTREAM

DAY 1

MANDALAY - KYAUK MYAUNG (MILES 45 * KM 83 – 6 HRS)

Board the Ship at Gawein Jetty (11.30-12.00 hrs), welcome cocktail and lunch. Sail upstream (ETD 12.30/13.00) and moor overnight at a river village North of Mandalay.

DAY 2

KYAUK MYAUNG - MINGUN – SAGAING (MILES 54 * KM 100 – 5 HRS)

Visit the spectacular **potteries-making village of Kyauk Myaung**, and see the manufacture stages of the famous **50 Gallons (200 Litres) pots** (1.5 hours visit). Cruise downstream to **Mingun**. Visit the unfinished pagoda, the largest working bell in the world and the “home for the aged”.

Moor overnight at Sagaing. Dance and Theatre performance on the Sundeck.

DAY 3

SAGAING – AVA - YANDABO (MILES 58 * KM 107 – 5 HRS)

Visit **Sagaing**, a hill studded with many Pagodas and Monasteries rich in wood carving and religious art, **Amarapura** the penultimate Burmese Royal Capital (1783) and **U-Bein Bridge**. On the way back to ship we stop at one of the several silk-weaving factories. Afternoon we travel by coach to the ancient city of **Ava**, capital of the Burmese Kingdom from 1364 to 1841. We explore the ruins by horse cart visiting the beautiful 200 year old **Bagaya Kyaung teak Monastery, Nanmyin watchtower** (27mt. high) and the **Me Nu Ok Kyaung monastery**. Return to the ship and cast off.

DAY 4

YANDABO – BAGAN (MILES 60 * KM 111 – 5 HRS)

Stop at **Yandabo**, a picturesque river village specializing in Pot-Making, where the peace treaty of the First Anglo-Burmese war signed on Feb. 24, 1826. Explore the village stopping to some pot-making workshops to learn their unique production technique, the school and the monastery.

Arrive in **Bagan** in the early evening.

DAY 5

BAGAN

We visit a selection of the 2,000 listed pagodas and temples and lacquerware shops in **Bagan**.

DAY 6

BAGAN – TAN KYI (7 MILES * 11 KM)

Further exploration of **Bagan**. Cast off at 15.30 and sail Downstream to reach the village of **Tan Kyi** on the opposite side of the river. Reach the mountaintop by WW2 jeep where stands one of the four stupas that marked the original edges of the city and enjoy a marvelous sunset over Bagan plain.

DAY 7

TAN KYI – SALAY (22 MILES * 35 KM) / SALAY – MAGWE (61 MILES * 98 KM)

Sail downstream to **Salay**, a 7,000 residents village founded in the 13th century with Bagan-era shrines, beautiful 19th century teak monasteries and preserved British colonial buildings. We visit the huge **Youqson Kyaung** wooden monastery designed as a copy of the Crown Prince House of Mandalay; we explore then an area of colonial buildings and some interesting Bagan-era monuments such as **Payathonzu** and the **Shinpinsarkyo Paya**. Back to the ship for lunch and proceed south to **Magwe**.



MANAGED BY AYRAVATA CRUISE COMPANY

DAY 8

MAGWE – MINHLA (19 MILES * 30 KM) / MINHLA – THAYETMYO (56 MILES * 90 KM)

Early morning visit **Myat Than Lun Paya**, a 1929 built pagoda set on a hilltop with a beautiful view of the river. We drive then to **Minbu** a small village across the river where we explore the **Nga Ka Pwe Taung (Dragon Lake)**, a burping pond of Butane Gas set in a moon-like plot of land with bubbling pools. Back to the boat and cast off before lunchtime. Stop in **Minhla** and **Gwechaung** to visit the two forts built by two Italian Military Engineers for the Burmese King in order to keep the British at bay from Royal Myanmar at the time of the 2nd Anglo-Burmese War. Proceed downstream to Thayetmyo, a pleasant colonial town.

DAY 9

THAYETMYO – PROME-PYAY (40 MILES * 64 KM)

Early Morning exploration of **Thayetmyo**: the oldest golf course of Myanmar, the market and the old colonial houses. Proceed sailing downstream. In late evening we arrive in **Prome (Pyay)** Once controlled by the Mon during the Bagan Era and then conquered by the Burmese King Alaungpaya in the 1754, this quiet town located 8 Km West of the famous ancient Pyu capital of Thayekhittaya, boomed along with the Irrawaddy Flotilla Company in the 1890's and it is now an important trading post.

DAY 10

PROME-PYAY (THAYEKHITTAYA)

Drive to **Thayekhittaya** (also known as Sri Ksetra, the fabulous city in Pali language), a huge ancient Pyu city that ruled in this area between the 5th and the 9th century AD. We visit also the impressive **Shwesandaw Pagoda complex**, one of the most important Buddhist pilgrimage sites of Myanmar, and the **Wunchataung Paya** (Apology Mountain Pagoda) a vantage point of the Shwesandaw Pagoda and the surrounding mountains.

DAY 11

PROME-PYAY (THAYEKHITTAYA) – YANGON (BY COACH)

Disembark and drive by coach to Yangon.

PRE AND POST DOWNSTREAM CRUISE TOUR

TOUR CODE GMD_PP1.2

YANGON STOPOVER

Duration: 2 nights / 3 Days

DAY 1 BEFORE THE CRUISE

RANGOON (YANGON)

International arrival to Yangon, transfer to the Hotel. Lunch in the hotel. In the afternoon orientation tour of the city ending with the visit of the most enchanting and spectacular Pagoda of Myanmar: **the Shwedagon**. Overnight at the historic **Strand Hotel** or Chatrium. Dinner at a local restaurant.

DAY 2 BEFORE THE CRUISE

RANGOON (YANGON) – MANDALAY (BY FLIGHT)

Transfer to the airport. Flight to Mandalay. Transfer to jetty.

DAY 1 AFTER THE CRUISE

YANGON

Check-in to **the Strand Hotel** or Chatrium. Afternoon visit **Sule Paya** and **Colonial downtown**. Dinner at the hotel.



MANAGED BY AYRAVATA CRUISE COMPANY

DAY 2 AFTER THE CRUISE

YANGON - DEPARTURE

International departures.



MANAGED BY AYRAVATA CRUISE COMPANY

THE ROYAL CAPITALS

BETWEEN BAGAN AND BEYOND MANDALAY

5 nights cruise on original PANDAW (1947) & 2 nights at a Yangon Hotel

UPSTREAM

DAY 1

BAGAN

Embark Pandaw 1947 at 08.30. We visit a selection of the 2,000 listed pagodas and temples and lacquerware shops. Dinner in a local restaurant. Overnight on board.

DAY 2

BAGAN – YANDABO (MILES 60*KM 111 – 12 HRS)

Cast off time at 10.30 hrs. We cruise upstream all day. Stop at **Shwe Pyi Thar village** for a walk. In the early evening we arrive at **Yandabo**, a picturesque village that specializes in Pot-Making, where the peace treaty of the First Anglo-Burmese war signed on Feb. 24, 1826. Dinner followed by a Puppet Show performance in the village or sundeck.

DAY 3

YANDABO – AVA/INWA (MILES 58*KM 107 – 12 HRS)

Early Morning we go ashore for a walk through the village stopping to some pot-making workshops to learn their unique production technique, the school and the monastery. Back to the ship for breakfast and cast off (ETD 09.00 hrs). We continue upstream to the ancient city of **Ava**, capital of the Burmese Kingdom from 1364 to 1841.

DAY 4

AVA - MANDALAY AMARAPURA - KYAUK MYAUNG (MILES 45*KM 83 – 9 HRS)

We explore **Ava** by horse-cart visiting the beautiful 200 year old teak **Bagaya Kyaung Monastery**, **Nanmyin watchtower** (27mt. high) and the **Me Nu Ok Kyaung monastery**. We travel by sampan and coach to **Amarapura**, the penultimate Burmese Royal Capital (1783) to visit **U-Bein Bridge** followed by central **Mandalay** visiting **Mahamuni Pagoda**, a **Gold leaf making workshop** and if time permits **Mandalay Hill**. Back to the ship for lunch and proceed upstream. Moor overnight nearby a river village North of Mandalay.

DAY 5

KYAUK MYAUNG - MINGUN – SAGAING (MILES 54*KM 100 – 5 HRS)

Visit the spectacular **potteries-making village of Kyauk Myaung**, and see the manufacture stages of the famous **50 Gallons (200 Litres) pots** (1.5 hours visit). Cruise downstream to **Mingun** where we visit the unfinished pagoda, the largest working bell in the world and the “home for the aged”.

Moor overnight at Sagaing. Dance and Theatre performance on the Sundeck.

DAY 6

SAGAING (DISEMBARK)

Disembark at Sagaing.



MANAGED BY AYRAVATA CRUISE COMPANY

PRE AND POST UPSTREAM CRUISE TOUR

TOUR CODE RCU_PP1.2

YANGON STOPOVER

Duration: 2 nights / 3 Days

DAY 1 BEFORE THE CRUISE

RANGOON (YANGON)

International arrival to Yangon, transfer to the Hotel. Lunch in the hotel. In the afternoon orientation tour of the city ending with the visit of the most enchanting and spectacular Pagoda of Myanmar: **the Shwedagon**. Overnight at the historic **Strand Hotel** or Chatrium Hotel. Dinner at a local restaurant.

DAY 2 BEFORE THE CRUISE

RANGOON (YANGON) – BAGAN (BY FLIGHT)

Early morning transfer to the airport. Flight to Bagan. Transfer to jetty.

DAY 1 AFTER THE CRUISE

MANDALAY – YANGON (BY FLIGHT)

Disembark at Sagaing. Flight to Yangon. Check-in to **the Strand Hotel** or Chatrium Hotel. Afternoon visit **Sule Paya** and **Colonial downtown**. Dinner at the hotel.

DOWNSTREAM

DAY 1

MANDALAY - KYAUK MYAUNG (MILES 45*KM 83 – 9 HRS)

Board the Ship at **Gawein Jetty** (11.30-12.00 hrs), welcome cocktail and lunch. Sail upstream (ETD 12.30/13.00) and moor overnight at a river village North of Mandalay.

DAY 2

KYAUK MYAUNG - MINGUN – SAGAING (MILES 54*KM 100 – 5 HRS)

Visit the spectacular **potteries-making village of Kyauk Myaung**, and see the manufacture stages of the famous **50 Gallons (200 Litres) pots** (1.5 hours visit). Cruise downstream to **Mingun**. Visit the unfinished pagoda, the largest working bell in the world and the “home for the aged”.

Moor overnight at Sagaing. Dance and Theatre performance on the Sundeck.

DAY 3

SAGAING – AMARAPURA – AVA - YANDABO (MILES 58 *KM 107 – 5 HRS)

Visit **Sagaing**, a hill studded with many Pagodas and Monasteries rich in wood carving and religious art, **Amarapura** the penultimate Burmese Royal Capital (1783) and **U-Bein Bridge**. On the way back to ship we stop at one of the several silk-weaving factories. Afternoon we travel by coach to the ancient city of **Ava**, capital of the Burmese Kingdom from 1364 to 1841. We explore the ruins by horse cart visiting the beautiful 200 years old **Bagaya Kyaung teak Monastery, Nanmyin watchtower** (27mt. high) and the **Me Nu Ok Kyaung monastery**. Return to the ship and cast off.

DAY 4

YANDABO – BAGAN (MILES 60*KM 111 – 5 HRS)

Stop at **Yandabo**, a picturesque river village specializing in Pot-Making, where the peace treaty of the First Anglo-Burmese war signed on Feb. 24, 1826. Explore the village stopping to some pot-making workshops to learn their unique production technique, the school and the monastery.



MANAGED BY AYRAVATA CRUISE COMPANY

Arrive in **Bagan** in the early evening.

DAY 5

BAGAN

We visit a selection of the 2,000 listed pagodas and temples and lacquerware shops in Bagan.

DAY 6

BAGAN (DISEMBARK)

Morning Disembark

PRE AND POST DOWNSTREAM CRUISE TOUR

TOUR CODE RCD_PP1.2

YANGON STOPOVER

Duration: 2 nights / 3 Days

DAY 1 BEFORE THE CRUISE

RANGOON (YANGON)

International arrival to Yangon, transfer to the Hotel. Lunch in the hotel. In the afternoon orientation tour of the city ending with the visit of the most enchanting and spectacular Pagoda of Myanmar: **the Shwedagon**. Overnight at the historic **Strand Hotel** or Chatrium Hotel. Dinner at a local restaurant.

DAY 2 BEFORE THE CRUISE

RANGOON (YANGON) – MANDALAY (BY FLIGHT)

Early morning transfer to the airport. Flight to Mandalay. Transfer to jetty.

DAY 1 AFTER THE CRUISE

BAGAN – YANGON (BY FLIGHT)

Disembark at Bagan. Flight to Yangon. Check-in to **the Strand Hotel** or Chatrium Hotel. Afternoon visit **Sule Paya** and **Colonial downtown**. Dinner at the hotel.

DAY 2 AFTER THE CRUISE

YANGON - DEPARTURE

International departures.



MANAGED BY AYRAVATA CRUISE COMPANY

RETAIL RATES

Per person in US\$ valid FROM 07 NOVEMBER 2011 TO 31 MAR 2012

GOLDEN MYANMAR

Cruise 10 Nights

Main Deck	Twin US\$2,900	Twin Single use US\$3,890
Upper Deck	Twin US\$3,550	Twin Single use: US\$4,615

Pre/Post Cruise Package (GMU PP1.2 - GMD PP1.2)

STRAND HOTEL		
Twin/Double Deluxe Suite US\$ 745		Twin/Double Deluxe Suite Single use US\$ 1,055
CHATRIUM HOTEL		
Twin/Double Superior US\$ 480		Twin/Double Superior Single use US\$ 565

THE ROYAL CAPITALS

Cruise 5 Nights

Main Deck	Twin US\$1,500	Twin Single use US\$1,950
Upper Deck	Twin US\$1,850	Twin Single use: US\$2,400

Pre/post cruise Package (RCU PP1.2 - RCD PP1.2)

STRAND HOTEL		
Twin/Double Deluxe Suite US\$ 895		Twin/Double Deluxe Suite Single use US\$ 1,120
CHATRIUM HOTEL		
Twin/Double Superior US\$ 635		Twin/Double Superior Single use US\$ 720

IMPORTANT NOTE: For All departures should the occupancy be less than 12 PASSENGERS the Company reserves the right to cancel the cruise up to 60 days prior the departure date. A written confirmation notice will be released to all booked clients and/or their agents within and not later than 60 days prior the departure date.

CRUISE PRICE INCLUDES All meals &, Coffee/Tea/Water - Sightseeing as described in the Itinerary – Ayravata Cruises English Speaking Guide (additional non-English speaking guide is provided if more than 8 cabins are booked by parties speaking the same language) - All Entrance Fees – *Transfer by coach to/from Prome*

CRUISE PRICE EXCLUDES Drinks, laundry, all items of a personal nature; health-accident-baggage or travel protection plan outside the ship's boundaries, fuel surcharges if applicable (*)

(*) Within the above rates the fuel cost is calculated on the Myanmar Market average price of the months of April 2010 (i.e. USD 3 per imperial gallon). Should the fuel price rise by more than 10%, AYRAVATA CRUISES will be entitled to impose a fuel surcharge equivalent to the amount by which the fuel price exceeds the price allowed for in the above rates, provided that the notice of this rise is given to the Passenger and/or his-her Agent within 30 days prior the cruise departure date.

Pre-Post Cruise Package Price includes 1+1 night accommodation at the Strand or Chatrium Hotel – Meals (Sightseeing as described in the Itinerary –English Speaking Guide (other languages with supplement) - All Entrance Fees – Transfers – Flights as mentioned in the program

Pre-Post Cruise Package Price excludes Drinks, laundry, all items of a personal nature; travel insurance, Compulsory meals and other supplements during holiday / festive season.



MANAGED BY AYRAVATA CRUISE COMPANY



MANAGED BY AYRAVATA CRUISE COMPANY

EXPLORATION CRUISES

GRAND VOYAGE OF THE CHINDWIN RIVER

A River Journey to discover the hidden treasures of the Golden Land

(BAGAN – PAKKOKU - PAKHAN-GYI - MONYWA – MINGIT - KALEWA – MAWLAYIK – MANDALAY)
(10 DAYS / 09 NIGHTS) – OPERATED WITH PANDAW 1947

DAY 1

*BAGAN – PAKKOKU (26 MILES*42 KM)*

Board RV Pandaw 1947 at 09.00 hrs. We cast off at 09.30 hrs and sail upstream to the Irrawaddy and Chindwin confluence. If time permits we stop in Thein Gone, a typical river village where we visit the school and the monastery. Continue cruising north to the bustling town of Pakkoku where we visit the monastery, cheroots and weaving workshops. We pass the Chindwin and Irrawaddy river confluence and we stop for the night.

DAY 2

*PAKKOKU - PAKHAN-GYI - AHMYINT VILLAGE – MONYWA (70 MILES*113 KM)*

Visit the little town of Pakhan-gyi. This post-Pagan period provincial capital was walled with a moat and originally had a governor's palace. We see the old walls; visit the museum and a spectacular 19th century wood carved monastery.

Continue cruising to Ahmyint village and visit the local market, see beautiful houses and the lovely the 17th century style Min Kyaw Swa stupas with 18th century style paintings.

Arrive at Monywa, the Chindwin River largest port, in the early evening.

DAY 3

MONYWA (HPOWINDAUNG AND SHWEBADAUNG CAVES)

Visit Hpowindaung and Shwebadaung caves where hundreds of Buddha Statues are placed inside niches decorated with wonderful mural paintings. If the weather and time permits we will also visit Twin Daung Lake better known as lake of "Spirulina", the famous green-blue algae rich in protein, vitamins and minerals. The origin of the lake is unknown, some geologist claim to be an extinct volcano crater, others a crater formed by a meteorite.

Alternatively we drive to Kyaukka village to visit a "plain" lacquer ware type workshop. Known as "Kyauk Kar" this kind of lacquerware has only two colors, black and red made by natural pigments. Late lunch and cast off.

DAY 4

MONYWA – KANI (34 MILES 55 KM) / KANI - KIN (30 MILES*48 KM)*

Late morning explore the village of Kanee and climb the pagoda hillock for its view. Continue sailing upstream until late at night to reach the village of Kani.

DAY 5

*KIN – MINGIN (MILES 40*64 KM)*

Early morning we explore Kin village with its beautiful wooden houses and the woodcarvings monastery. Continue sailing upstream to the small enchanting town of Mingin. Explore its temples and 1900's wooden houses and the Min Kyaung Monastery with old Buddha Images.



MANAGED BY AYRAVATA CRUISE COMPANY

DAY 6

*MINGIN - KYIDAW (1.5 MILES*2.4 KM) / KYIDAW – KALEWA (42 MILES*68 KM)*

At Kyidaw (Kyi Taung Oo) we visit Shwe Za War Yaw monastery one of the oldest and best preserved wood carved monastery of Myanmar, embellished with wooden sculpted idols with fascinating gold leaf wall decorations. We walk through a beautiful scenario of paddy fields to the village of Kan where we visit another splendid example of Myanmar old monastery. Afterwards we return to the ship by local boat.

Proceed upstream up to Kyaw Zin, a village very close to Kalewa, where we stop for the night.

DAY 7

*KALEWA – MAWLAYIK (38 MILES*61 KM)*

In the morning we explore Kalewa, the main river port for the trading with India, the lively market and climb up to Shwe Moat Htaw stupa for the beautiful view.

Back to the ship before lunch and keep on cruising upstream to Mawlaik.

DAY 8

MAWLAIK – SAILING BACK DOWNSTREAM

Mawlaik (situated 35 km from the Indian Border) was the administrative capital of this area rich of Teak forests. It is a pleasant colonial town with its golf course surrounded by splendid colonial houses built by the Bombay Burmah Trading Corporation in the 1920's and 1930's (there is still a small community of Indians that used to work for the Scottish company and their descendents). The governor's house, the administrative building, the school, the hospital, the "Dak Bungalows", company headquarter are well preserved, still in use nowadays and nicely maintained.

Being this our turnaround point, we begin sailing back downstream to Monywa.

DAY 9

SAILING DOWNSTREAM FOR 100 MILES (160 KM)

Continue sailing all day downstream. Stop at Kyauk Hlay Gar village, famous for its Petrified Wood, where we visit the school and the typical houses.

DAY 10

MONYWA - MANDALAY

Arrive at Monywa in the morning. Transfer by coach to Mandalay with stop enroute to visit the splendid Sambuddhai Kat Kyaw pagoda where more than 500,000 Buddha statues are placed and the Aung Sakyar Stupa with the longest reclining Buddha of Myanmar (333 ft/100 m). Lunch at a restaurant in Sagaing. Continue to your Mandalay Hotel or Airport.



MANAGED BY AYRAVATA CRUISE COMPANY

PRE AND POST CRUISE TOURS

TOUR CODE GVD_PP1.3

YANGON / BAGAN STOPOVER

Duration: 3 nights / 4 Days

DAY 1 BEFORE THE CRUISE

RANGOON (YANGON)

International arrival to Yangon, transfer to the Hotel. Lunch in the hotel. In the afternoon orientation tour of the city ending with the visit of the most enchanting and spectacular Pagoda of Myanmar: **the Shwedagon**. Overnight at the historic Strand or Chatrium Hotel. Dinner at a local restaurant.

DAY 2 BEFORE THE CRUISE

RANGOON (YANGON) – BAGAN (BY FLIGHT)

Early morning transfer to the airport. Flight to Bagan, one of the Asia's most important archaeological sites and one out of two most eminent religious old cities in South East Asia. The sightseeing starts with a visit to Nyaung Oo market – a typical local market; followed by visits to most distinctive pagodas such as Shwezigon Pagoda – the holiest one believed to be enshrined with Buddha tooth and hair; Gubyaukgyi Temple (Wetkyiinn village) – the 13th century 'cave temple' with fine frescoes of scenes from Jakatas; Anada Temple – one of the masterpieces surviving and remaining in Bagan and considered to be in the Mon architecture style. Afternoon, we will visit a lacquer ware factory followed by a visit to local village. We will view the sunset from the top of one of the temples. Lunch and Dinner at local restaurant.

DAY 3 BEFORE THE CRUISE

BAGAN (EMBARK THE SHIP)

Transfer to the Jetty.

DAY 1 AFTER THE CRUISE

MANDALAY – YANGON (BY AFTERNOON FLIGHT)

Flight to Yangon (or Heho for the Inle Extension tour). Check-in to the Strand Hotel or Chatrium Hotel. Lunch and Dinner at local restaurant.

DAY 2 AFTER THE CRUISE

YANGON - DEPARTURE

Visit **Sule Paya** and **Colonial downtown**. Lunch at local restaurant. International departures.

TOUR CODE GVD_PP2.4

YANGON STOPOVER

Duration: 4 nights / 3 Days

DAY 1 BEFORE THE CRUISE

RANGOON (YANGON)

International arrival to Yangon, transfer to the Hotel. Lunch in the hotel. In the afternoon orientation tour of the city ending with the visit of the most enchanting and spectacular Pagoda of Myanmar: **the Shwedagon**. Overnight at the historic Strand Hotel or Chatrium Hotel. Dinner at a local restaurant.



MANAGED BY AYRAVATA CRUISE COMPANY

DAY 2 BEFORE THE CRUISE

RANGOON (YANGON) – BAGAN (BY FLIGHT)

Early morning transfer to the airport. Flight to Bagan, one of the Asia's most important archaeological sites and one out of two most eminent religious old cities in South East Asia. The sightseeing starts with a visit to Nyaung Oo market – a typical local market; followed by visits to most distinctive pagodas such as Shwezigon Pagoda – the holiest one believed to be enshrined with Buddha tooth and hair; Gubyaukgyi Temple (Wetkyiinn village) – the 13th century 'cave temple' with fine frescoes of scenes from Jakatas; Anada Temple – one of the masterpieces surviving and remaining in Bagan and considered to be in the Mon architecture style. Afternoon, we will visit a lacquer ware factory followed by a visit to local village. We will view the sunset from the top of one of the temples. Lunch and Dinner at local restaurant. Overnight at Tharabar or Thiripitsaya Hotel.

DAY 3 BEFORE THE CRUISE

BAGAN (EMBARC THE SHIP)

Transfer to the Jetty.

DAY 1 AFTER THE CRUISE

MANDALAY

Arrive Mandalay after lunch. Check-in to the Hotel. Late Afternoon visit Kuthodaw Pagoda, renowned as the world's largest book; and Mandalay Hill, regarded a natural watch tower in the plain region of Mandalay, to view the sunset. Dinner at a Local Restaurant. Overnight at Mandalay Hill Hotel.

DAY 2 AFTER THE CRUISE

MANDALAY - YANGON

Excursion to Ancient Capital Amarapura, 11 Kilometers south of Mandalay visiting Mahagandayon monastery; 1.2 kilometer long U Bein Wooden Bridge and silk-weaving factory. Lunch at the hotel. Check out. Afternoon visit Maha Muni Buddha Image and (if time permits) continue to Shwe Kyaung monastery before driving to the airport for the flight to Yangon. Check-in to the Strand Hotel or Chatrium Hotel. Dinner at a local restaurant.

DAY 3 AFTER THE CRUISE

YANGON - DEPARTURE

Visit **Sule Paya** and **Colonial downtown**. Lunch at local restaurant. International departures.



MANAGED BY AYRAVATA CRUISE COMPANY

RETAIL RATES

Per person in US\$ valid SEPTEMBER 2011

VOYAGE OF CHINDWIN RIVER

Cruise 9 Nights

Main Deck	Twin US\$3,150	Twin Single use US\$4,090
Upper Deck	Twin US\$3,600	Twin Single use: US\$4,680

Pre/Post Cruise Packages

Tour Code GVD_PP1.3 / 3 nights

STRAND HOTEL		
Twin/Double Deluxe Suite US\$ 1,300		Twin/Double Deluxe Suite Single use US\$ 1,685

CHATRIUM HOTEL		
Twin/Double Superior US\$ 785		Twin/Double Superior Single use US\$ 945

Tour Code GVD_PP2.4 / 4 nights

STRAND HOTEL		
Twin/Double Deluxe Suite US\$ 1,220		Twin/Double Deluxe Suite Single use US\$ 1,665

CHATRIUM HOTEL		
Twin/Double Superior US\$ 995		Twin/Double Superior Single use US\$ 1,215

CRUISE PRICE INCLUDES

All meals &, Coffee/Tea/Water - Sightseeing as described in the Itinerary – Ayravata Cruises English Speaking Guide (additional non-English speaking guide is provided if more than 8 cabins are booked by parties speaking the same language) - All Entrance Fees.

CRUISE PRICE EXCLUDES

Transfer from/to Mandalay or Bagan Hote-Airport. Drinks, laundry, all items of a personal nature; health-accident-baggage or travel protection plan outside the ship's boundaries, fuel surcharges if applicable, domestic flights.

(*) Within the above rates the fuel cost is calculated on the Myanmar Market average price of the months of January 2010 (i.e. USD 3 per imperial gallon). Should the fuel price rise by more than 10%, AYRAVATA CRUISES will be entitled to impose a fuel surcharge equivalent to the amount by which the fuel price exceeds the price allowed for in the above rates, provided that the notice of this rise is given to the Passenger and/or his-her Agent within 30 days prior the cruise departure date.

Pre-Post Cruise Package Price includes Hotels accommodation – Meals Sightseeing as described in the Itinerary –English Speaking Guide (other languages with supplement) - All Entrance Fees – Transfers – Flights as mentioned in the program

Pre-Post Cruise Package Price excludes Drinks, laundry, all items of a personal nature; travel insurance, Compulsory meals and other supplements during holiday / festive season.

IMPORTANT NOTICE

The Chindwin River Cruises will be operated ONLY if there is a minimum of 12 passengers booked.

The cruise confirmation deadline is 90 days prior the departure date.



MANAGED BY AYRAVATA CRUISE COMPANY

MYANMAR DAYS The Bhamo Cruise

A River Journey to discover the upper reaches of the Irrawaddy

(MANDALAY – MINGUN – TAGAUNG - KATHA – BHAMO – KYAUK MYAUNG - MANDALAY)
(8 DAYS / 07 NIGHTS) – OPERATED WITH PANDAW 1947

DAY 1

MANDALAY (GAWEIN) – MINGUN (MILES 6*KM 9.6 – 1 HR)

Embark the ship at 12.30 hrs. We cast off at 13.00 hrs and sail upstream to **Mingun**. Visit the unfinished pagoda, the largest working bell in the world and the “home for the ages”. Moor overnight nearby a river village.

DAY 2

MINGUN – RIVER VILLAGE (MILES 20*KM 32 – 3.3 HRS)

Cast off early in the morning. Stop at a **typical river village** for sightseeing. We enter the **Third Defile (Gorge)**. Moor overnight nearby a river village.

DAY 3

RIVER VILLAGE - TAGAUNG (MILES 75*KM 120– 12.5 HRS)

Stop at **Tagaung** to explore the **ancient city** archaeological area and the fortifications around 9:00 am. Continue sail upstream all day. Moor overnight nearby a river village.

DAY 4

TAGAUNG - KATHA (MILES 66*KM 105.6 – 11 HRS)

After breakfast we arrive **Katha**, the setting of the George Orwell’s book “**Burmese Days**” and also the place where hundreds of the Irrawaddy Flotilla Company ships were scuttled in 1942 before the Japanese could seize them. We explore this pleasant colonial town surrounded by hills plenty of hardwood forests and “**Elephant Logging Camp**” located west of Katha. If time permit we will also visit the **lake Indaw**. Moor overnight nearby Sin Khan village.

DAY 5

KATHA - BHAMO (MILES 84*KM 134.4 - 14 HRS)

We continue sailing upstream to **Bhamo** and walking tour of the town, an important trading post located just 50 miles from the Chinese border. After lunch, we will try to reach the village of **Sinbo** set below the **1st Defile** by local boat. Moor overnight at Bhamo.

DAY 6

BHAMO – KATHA (MILES 84 *KM 134.4/7.6 HRS)

After breakfast, we enter the **dramatic 2nd defile** with its magnificent cliffs reaching down the narrow channel and visit a **typical river village**. Back to the ship before lunch and cast off for the Downstream return journey to Mandalay. Moor overnight at River Village.

DAY 7

KATHA – KYAUK MYAUNG (MILES 141*KM 225.6/12.8 HRS)

Cruise all day. Arrive the spectacular **potteries-making village of Kyauk Myaung** around early evening, and see the manufacture stages of the famous **50 Gallons (200 liters) pots** (1.5 hours visit).



MANAGED BY AYRAVATA CRUISE COMPANY

We arrive near Htone Gyi Village around late evening. **Dance and Theatre performance from Mandalay Art School** on the Sundeck. Moor overnight near a river village.

DAY 8

*MINGUN – MANDALAY / GAWEIN (MILES 6*KM 9.6 / 50 MIN.)*

After breakfast, disembark at Mandalay Gawein Jetty around 10:00 hrs.

PRE AND POST CRUISE TOURS

TOUR CODE MDA_PP1.2

YANGON STOPOVER

Duration: 2 nights / 3 Days

DAY 1 BEFORE THE CRUISE

RANGOON (YANGON)

International arrival to Yangon, transfer to the Hotel. Lunch in the hotel. In the afternoon orientation tour of the city ending with the visit of the most enchanting and spectacular Pagoda of Myanmar: **the Shwedagon**. Overnight at the historic **Strand Hotel** or Chatrium Hotel. Dinner at a local restaurant.

DAY 2 BEFORE THE CRUISE

RANGOON (YANGON) – MANDALAY (BY FLIGHT)

Early morning transfer to the airport. Flight to Mandalay. Transfer to jetty.

DAY 1 AFTER THE CRUISE

MANDALAY – YANGON (BY AFTERNOON FLIGHT)

Disembark. Tour Central Mandalay before the transfer to the airport for the flight to Yangon (or Heho for the Inle Extension tour). Check-in to **the Strand Hotel** or Chatrium Hotel. Lunch and Dinner at local restaurant.

DAY 2 AFTER THE CRUISE

YANGON - DEPARTURE

Visit **Sule Paya** and **Colonial downtown**. Lunch at local restaurant .International departures.

TOUR CODE MDA_PP2.3

YANGON / BAGAN STOPOVER

Duration: 3 nights / 4 Days

DAY 1 BEFORE THE CRUISE

RANGOON (YANGON)

International arrival to Yangon, transfer to the Hotel. Lunch in the hotel. In the afternoon orientation tour of the city ending with the visit of the most enchanting and spectacular Pagoda of Myanmar: **the Shwedagon**. Overnight at the historic **Strand Hotel** or Chatrium Hotel. Dinner at a local restaurant.

DAY 2 BEFORE THE CRUISE

RANGOON (YANGON) – BAGAN (BY FLIGHT)

Early morning transfer to the airport. Flight to Bagan, one of the Asia's most important archaeological sites and one out of two most eminent religious old cities in South East Asia. The sightseeing starts with a visit to Nyaung Oo market – a typical local market; followed by visits to most distinctive pagodas such as Shwezigon Pagoda – the holiest one believed to be enshrined with Buddha tooth and hair; Gubyaukgyi Temple (Wetkyiinn village) – the 13th century 'cave temple' with fine frescoes of scenes



MANAGED BY AYRAVATA CRUISE COMPANY

from Jakatas; Anada Temple – one of the masterpieces surviving and remaining in Bagan and considered to be in the Mon architecture style. Afternoon, we will visit a lacquer ware factory followed by a visit to local village. We will view the sunset from the top of one of the temples. Lunch and Dinner at local restaurant.

DAY 3 BEFORE THE CRUISE

BAGAN – MANDALAY (BY FLIGHT)

Early morning Transfer to the airport for the flight to Mandalay. Transfer to the Jetty.

DAY 1 AFTER THE CRUISE

MANDALAY – YANGON (BY AFTERNOON FLIGHT)

Disembark. Tour Central Mandalay before the transfer to the airport for the flight to Yangon (or Heho for the Inle Extension tour). Check-in to **the Strand Hotel** or Chatrium Hotel. Lunch and Dinner at local restaurant.

DAY 2 AFTER THE CRUISE

YANGON - DEPARTURE

Visit **Sule Paya** and **Colonial downtown**. Lunch at local restaurant .International departures.



MANAGED BY AYRAVATA CRUISE COMPANY

RETAIL RATES

Per person in US\$ valid OCTOBER & NOVEMBER 2011

MYANMAR DAYS – The Bhamo cruise

Cruise 7 Nights

Main Deck	Twin US\$2,450	Twin Single use US\$3,180
Upper Deck	Twin US\$2,800	Twin Single use: US\$3,640

Pre/Post Cruise Packages

Tour Code MDA_PP1.2 / 2 nights

STRAND HOTEL		
Twin/Double Deluxe Suite US\$ 970		Twin/Double Deluxe Suite Single use US\$ 1,280
CHATRIUM HOTEL		
Twin/Double Superior US\$ 710		Twin/Double Superior Single use US\$ 795

Tour Code MDA_PP2.3 / 3 nights

STRAND HOTEL		
Twin/Double Deluxe Suite US\$ 1,150		Twin/Double Deluxe Suite Single use US\$ 1,535
CHATRIUM HOTEL		
Twin/Double Superior US\$ 890		Twin/Double Superior Single use US\$ 1,050

CRUISE PRICE INCLUDES

All meals &, Coffee/Tea/Water - Sightseeing as described in the Itinerary – Ayravata Cruises English Speaking Guide (additional non-English speaking guide is provided if more than 8 cabins are booked by parties speaking the same language) - All Entrance Fees

CRUISE PRICE EXCLUDES

Drinks, laundry, all items of a personal nature; health-accident-baggage or travel protection plan outside the ship's boundaries, fuel surcharges if applicable, domestic flights.

(*) Within the above rates the fuel cost is calculated on the Myanmar Market average price of the months of January 2010 (i.e. USD 3 per imperial gallon). Should the fuel price rise by more than 10%, AYRAVATA CRUISES will be entitled to impose a fuel surcharge equivalent to the amount by which the fuel price exceeds the price allowed for in the above rates, provided that the notice of this rise is given to the Passenger and/or his-her Agent within 30 days prior the cruise departure date.

Pre-Post Cruise Package Price includes Hotels accommodation – Meals Sightseeing as described in the Itinerary –English Speaking Guide (other languages with supplement) - All Entrance Fees – Transfers – Flights as mentioned in the program

Pre-Post Cruise Package Price excludes Drinks, laundry, all items of a personal nature; travel insurance, Compulsory meals and other supplements during holiday / festive season.

IMPORTANT NOTICE

For All departures should the occupancy be less than 12 PASSENGERS the Company reserves the right to cancel the cruise up to 60 days prior the departure date. A written confirmation notice will be released to all booked clients and/or their agents within and not later than 60 days prior the departure date. In case of cancellation an alternative cruise will be offered and if not acceptable all down payments will be refunded.



MANAGED BY AYRAVATA CRUISE COMPANY

INLE LAKE EXTENSION PACKAGE (1N/2D)

DAY 1

HEHO - INLE LAKE

Transfer from the Heho airport to the hotel by the lake shore.

Inle Lake, located 900 meters above sea level surrounded by beautiful mountains of the Shan plateau, is the home land of the Inthar tribe famous not only for their unique leg-rowing style and fishing method but also for the floating gardens used as vegetable plantations. If by chance today coincides with the market day, we will visit the regional market which is held on a 5 days rotation basis in different areas of the Lake. We will visit **Phaungdawoo Pagoda** – famous for its richly gilded five small Buddha images; **Ngaphechaung monastery** (also known as jumping cat monastery) was built more than one and a half century ago and features a number of interesting old Buddha Images; silk and cotton weaving cottages and black smith. Lunch in a local restaurant and Dinner at the hotel.

DAY 2

INDEIN – HEHO

We explore the southern part of the Lake by boat sailing through small twisting and turning creeks to reach **Indein village**. This small village located on the southwestern bank of the lake is famous for its ruined clusters of pagodas dated back to 16th century. The tranquil peaceful ambience and the ruins overgrown with bushes will bring you centuries back. After lunch you will be transferred to the airport for your onward flight.

PACKAGE PRICE

2D/ 1N AT LAKE VIEW HOTEL

Twin/Double Deluxe US\$ 390

Twin/Double Deluxe Single use US\$ 470

Price includes

1 night accommodation at the Lake View Hotel – Meals and Sightseeing as described in the Itinerary – English Speaking Guide (other languages with supplement) - All Entrance Fees – Land Transfers – Flight Mandalay or Bagan / Heho

Price excludes

Drinks, laundry, all items of a personal nature; Insurance, compulsory meals and other supplements during holiday / festive season.



MANAGED BY AYRAVATA CRUISE COMPANY

PARTNER HOTELS

YANGON

THE STRAND

Doubtless, by reason of its proximity to the passenger wharves, the Strand Hotel is the best-known hotel in Rangoon. Specially built to the plans of the proprietors, Messrs. Sarkies Bros., it was opened in 1901. The lighting throughout is by electricity, the current for this and for the fans being generated on the premises. The water supply is drawn from an artesian well, and the cuisine is under the direction of a French chef. The proprietors first started business in Rangoon in 1892 by acquiring the British Burma Hotel, which stood on the site now occupied by the Burma Club in Merchant Street. Four years later they disposed of the property, which at that time was known as Sarkies Hotel, and in 1897 opened the Bodega Restaurant at the corner of Merchant Street and Phayre Street. Another four years saw Messrs. Sarkies Bros. in the Strand Hotel. The same proprietors also own Raffles Hotel at Singapore. The Crag Hotel and the Eastern and Oriental Hotels at Penang and the Majestic Hotel, which is now in course of erection in Calcutta. (A. WRIGHT, 1910)

STRAND HOTEL



THIS Premier Hotel of Burma is the most modern in Rangoon. It commands the best position in the City, faces the river, is in close proximity to all the Banks, the Post and Telegraph Offices, Shops, Shipping Offices, etc. The apartments of the Hotel consist of Sitting rooms, Bed and Dressing rooms with Bath room attached. For comfort and convenience the Tourists and Commercial Travellers cannot find anywhere else, but in the Strand Hotel. Under the able management of Mr. Joe Constantine, who was connected with Raffles Hotel, Singapore, for many years, the Strand Hotel has gained popularity amongst the travelling public.

SARKIES BROTHERS,
Proprietors.

Reopened in the 1993 after extensive renovations the hotel's 32 beautifully appointed suites are the essence of timeless elegance. For a really grand experience, there's the spacious Strand Suite with its own verandah overlooking the river. For more details: www.ghmhotels.com



CHATRIUM

This hotel-resort is located along the western shore of Royal Lake (Kandawgyi Lake) facing the magnificent Shwe Dagon Pagoda. The building was designed in a typical contemporary Asian style with Oriental and Colonial architectonic details on a total land area of almost 4 acres. The all glass window panels of the lobby and restaurants allow the sunlight to create a natural ambience. The traditional décor and the gallery-like atmosphere of the lobby area assure an experience true to the spirit of traditional Asia. Opened in the 1998 it has 303 guestrooms including 37 luxurious suites featuring a wood-accented décor employing traditional fabrics, tapestries and furniture of Myanmar. Curiosity: the land where it was built was once owned by the renowned family of Tiger Balm in 1900's and later the prosperous land spot was called "Tiger Hill". www.chatriumhotelyangon.com



MANAGED BY AYRAVATA CRUISE COMPANY

MANDALAY

HILL RESORT

Mandalay Hill Resort Hotel lies at the foot of Mandalay Hill with a panoramic view of a myriad of pagodas. It also faces the distinctive architecture of the Royal Palace and its beautiful moat. The Resort is situated within easy reach of many ancient monuments and historical sites. The hotel has 206 rooms in total. <http://www.mandalayhillresorthotel.com>

BAGAN

THIRIPYITSAYA SAKURA SANCTUARY RESORT

Beautifully located on the banks of the mighty Irrawaddy River in the historical Old Bagan and Adjacent to the archaeological museum, 10 minutes drive from the airport, the hotel was the first international hotel in Bagan and probably the one with the best setting.

The 76 rooms (each offers a spacious, private veranda) are divided into 17 low-slung villas scattered through the big English-style garden. Ayravata Cruises clients will be booked only in the 28 Deluxe Garden or the 9 River view rooms (26sqm).

We recommend also the 4 River Front Suites or the 4 River View Suites (78 sqm) located in a two storey building either in the ground floor (River front) or upper (River view) floor with a splendid view of the Irrawaddy River.

Facilities: Myanmar, Thai and Western style dining at the air-conditioned Nadi Restaurant, the Sunset Terrace or the open-air Veranda Grill & Bar. Enjoy cocktail at the Pavilion, an open-air Lounge with panoramic view. An extensive range of massages at the Spa, a souvenir shop, Arts and Gems centre.

<http://www.thiripyitsaya-resort.com/index.html>



INLE LAKE

INLE LAKE VIEW RESORT

The Inle Lake View Resort is built on 15 acres of lush land of trees and flowers, ideally located in a picturesque area overlooking the Inle Lake. Located on the western edge of the lake, the hotel offers luxury and elegance throughout. It offers 38 rooms, large and spacious, all with private balcony and excellent views on to the Lake, tastefully decorated in Burman – Asian style furniture and soft tropical hues. 20 Deluxe (king or twin) 45-55 sq.m / 16 Junior Suites 70 sqm / 2 Lake Side Villa 100 sq.m

Facilities: The Bougainvillea Restaurant | The Lotus Bar | Inle Lake View Spa | La-Boutique



MANAGED BY AYRAVATA CRUISE COMPANY

For more details: www.inlelakeview.com



MANAGED BY AYRAVATA CRUISE COMPANY

SAILING DATES 2011-2012 (*)

SORTED BY CRUISES (ALPHABETIC ORDER)

BETWEEN ROYAL MANDALAY AND ANCIENT BAGAN

MANDALAY TO BAGAN (1 NIGHT) - DEPARTURE DAYS: THURSDAY

CODE	DEP DATE	ARR DATE	VESSEL	CODE	DEP DATE	ARR DATE	VESSEL
MB011PK12	20/10/11	21/10/11	PAUKAN	MB151PK12	26/01/12	27/01/12	PAUKAN
MB021PK12	27/10/11	28/10/11	PAUKAN	MB161PK12	02/02/12	03/02/12	PAUKAN
MB031PK12	03/11/11	04/11/11	PAUKAN	MB171PK12	09/02/12	10/02/12	PAUKAN
MB041PK12	10/11/11	11/11/11	PAUKAN	MB181PK12	16/02/12	17/02/12	PAUKAN
MB051PK12	17/11/11	18/11/11	PAUKAN	MB191PK12	23/02/12	24/02/12	PAUKAN
MB061PK12	24/11/11	25/11/11	PAUKAN	MB201PK12	01/03/12	02/03/12	PAUKAN
MB071PK12	01/12/11	02/12/11	PAUKAN	MB211PK12	08/03/12	09/03/12	PAUKAN
MB081PK12	08/12/11	09/12/11	PAUKAN	MB221PK12	15/03/12	16/03/12	PAUKAN
MB091PK12	15/12/11	16/12/11	PAUKAN	MB231PK12	22/03/12	23/03/12	PAUKAN
MB101PK12	22/12/11	23/12/11	PAUKAN	MB241PK12	29/03/12	30/03/12	PAUKAN
MB111PK12	29/12/11	30/12/11	PAUKAN	MB251PK12	05/04/12	06/04/12	PAUKAN
MB121PK12	05/01/12	06/01/12	PAUKAN	MB261PK12	12/04/12	13/04/12	PAUKAN
MB131PK12	12/01/12	13/01/12	PAUKAN	MB271PK12	19/04/12	20/04/12	PAUKAN
MB141PK12	19/01/12	20/01/12	PAUKAN	MB281PK12	26/04/12	27/04/12	PAUKAN

BAGAN TO MANDALAY (2 NIGHTS) * DEPARTURE DAYS: TUESDAY, FRIDAY

CODE	DEP DATE	ARR DATE	VESSEL	CODE	DEP DATE	ARR DATE	VESSEL
BM012PK12	18/10/11	20/10/11	PAUKAN	BM292PK12	24/01/12	26/01/12	PAUKAN
BM022PK12	21/10/11	23/10/11	PAUKAN	BM302PK12	27/01/12	29/01/12	PAUKAN
BM032PK12	25/10/11	27/10/11	PAUKAN	BM312PK12	31/01/12	02/02/12	PAUKAN
BM042PK12	28/10/11	30/10/11	PAUKAN	BM322PK12	03/02/12	05/02/12	PAUKAN
BM052PK12	01/11/11	03/11/11	PAUKAN	BM332PK12	07/02/12	09/02/12	PAUKAN
BM062PK12	04/11/11	06/11/11	PAUKAN	BM342PK12	10/02/12	12/02/12	PAUKAN
BM072PK12	08/11/11	10/11/11	PAUKAN	BM352PK12	14/02/12	16/02/12	PAUKAN
BM082PK12	11/11/11	13/11/11	PAUKAN	BM362PK12	17/02/12	19/02/12	PAUKAN
BM092PK12	15/11/11	17/11/11	PAUKAN	BM372PK12	21/02/12	23/02/12	PAUKAN
BM102PK12	18/11/11	20/11/11	PAUKAN	BM382PK12	24/02/12	26/02/12	PAUKAN
BM112PK12	22/11/11	24/11/11	PAUKAN	BM392PK12	28/02/12	01/03/12	PAUKAN
BM122PK12	25/11/11	27/11/11	PAUKAN	BM402PK12	02/03/12	04/03/12	PAUKAN
BM132PK12	29/11/11	01/12/11	PAUKAN	BM412PK12	06/03/12	08/03/12	PAUKAN
BM142PK12	02/12/11	04/12/11	PAUKAN	BM422PK12	09/03/12	11/03/12	PAUKAN
BM152PK12	06/12/11	08/12/11	PAUKAN	BM432PK12	13/03/12	15/03/12	PAUKAN
BM162PK12	09/12/11	11/12/11	PAUKAN	BM442PK12	16/03/12	18/03/12	PAUKAN
BM172PK12	13/12/11	15/12/11	PAUKAN	BM452PK12	20/03/12	22/03/12	PAUKAN
BM182PK12	16/12/11	18/12/11	PAUKAN	BM462PK12	23/03/12	25/03/12	PAUKAN
BM192PK12	20/12/11	22/12/11	PAUKAN	BM472PK12	27/03/12	29/03/12	PAUKAN
BM202PK12	23/12/11	24/12/11	PAUKAN	BM482PK12	30/03/12	01/04/12	PAUKAN
BM212PK12	27/12/11	29/12/11	PAUKAN	BM492PK12	03/04/12	05/04/12	PAUKAN



MANAGED BY AYRAVATA CRUISE COMPANY

BM222PK12	30/12/11	01/01/12	PAUKAN	BM502PK12	06/04/12	08/04/12	PAUKAN
BM232PK12	03/01/12	05/01/12	PAUKAN	BM512PK12	10/04/12	12/04/12	PAUKAN
BM242PK12	06/01/12	08/01/12	PAUKAN	BM522PK12	13/04/12	15/04/12	PAUKAN
BM252PK12	10/01/12	12/01/12	PAUKAN	BM532PK12	17/04/12	19/04/12	PAUKAN
BM262PK12	13/01/12	15/01/12	PAUKAN	BM542PK12	20/04/12	22/04/12	PAUKAN
BM272PK12	17/01/12	19/01/12	PAUKAN	BM552PK12	24/04/12	26/04/12	PAUKAN
BM282PK12	20/01/12	22/01/12	PAUKAN	BM562PK12	27/04/12	29/04/12	PAUKAN

(#) NEW YEAR'S EVE CRUISE DEPARTURE (30 DECEMBER 2011): RATES & DETAILED PROGRAMME TBA

MANDALAY TO BAGAN (2 NIGHTS) / DEPARTURE DAY: SUNDAY

CODE	DEP DATE	ARR DATE	VESSEL	CODE	DEP DATE	ARR DATE	VESSEL
MB012PK12	16/10/11	18/10/11	PAUKAN	MB162PK12	29/01/12	31/01/12	PAUKAN
MB022PK12	23/10/11	25/10/11	PAUKAN	MB172PK12	05/02/12	07/02/12	PAUKAN
MB032PK12	30/10/11	01/11/11	PAUKAN	MB182PK12	12/02/12	14/02/12	PAUKAN
MB042PK12	06/11/11	08/11/11	PAUKAN	MB192PK12	19/02/12	21/02/12	PAUKAN
MB052PK12	13/11/11	15/11/11	PAUKAN	MB202PK12	26/02/12	28/02/12	PAUKAN
MB062PK12	20/11/11	22/11/11	PAUKAN	MB212PK12	04/03/12	06/03/12	PAUKAN
MB072PK12	27/11/11	29/11/11	PAUKAN	MB222PK12	11/03/12	13/03/12	PAUKAN
MB082PK12	04/12/11	06/12/11	PAUKAN	MB232PK12	18/03/12	20/03/12	PAUKAN
MB092PK12	11/12/11	13/12/11	PAUKAN	MB242PK12	25/03/12	27/03/12	PAUKAN
MB102PK12	18/12/11	20/12/11	PAUKAN	MB252PK12	01/04/12	03/04/12	PAUKAN
MB112PK12	25/12/11	27/12/11	PAUKAN	MB262PK12	08/04/12	10/04/12	PAUKAN
MB122PK12	01/01/12	03/01/12	PAUKAN	MB272PK12	15/04/12	17/04/12	PAUKAN
MB132PK12	08/01/12	10/01/12	PAUKAN	MB282PK12	22/04/12	24/04/12	PAUKAN
MB142PK12	15/01/12	17/01/12	PAUKAN	MB292PK12	29/04/12	01/05/12	PAUKAN
MB152PK12	22/01/12	24/01/12	PAUKAN				

GOLDEN MYANMAR

10 NIGHTS

UPSTREAM

CODE	DEP DATE	ARR DATE	VESSEL	CODE	DEP DATE	ARR DATE	VESSEL
GM08U12	18/11/11	28/11/11	PANDAW	GM12U12	10/02/12	20/02/12	PANDAW
GM09U12	09/12/11	19/12/11	PANDAW	GM13U12	02/03/12	12/03/12	PANDAW
GM10U12	30/12/11	09/01/12	PANDAW	GM14U12	23/03/12	02/04/12	PANDAW
GM11U12	20/01/12	30/01/12	PANDAW				

(#) NEW YEAR'S EVE CRUISE DEPARTURE (30 DECEMBER 2011): RATES & DETAILED PROGRAMME TBA

DOWNSTREAM

CODE	DEP DATE	ARR DATE	VESSEL	CODE	DEP DATE	ARR DATE	VESSEL
GM08D12	07/11/11	17/11/11	PANDAW	GM12D12	30/01/12	09/02/12	PANDAW
GM09D12	28/11/11	08/12/11	PANDAW	GM13D12	20/02/12	01/03/12	PANDAW
GM10D12	19/12/11	29/12/11	PANDAW	GM14D12	12/03/12	22/03/12	PANDAW
GM11D12	09/01/12	19/01/12	PANDAW				

GRAND VOYAGE OF THE CHINDWIN RIVER

9 NIGHTS – 1 DEPARTURE

CODE	DEP DATE	ARR DATE	VESSEL	CODE	DEP DATE	ARR DATE	VESSEL
TGV00112	20/09/11	29/09/11	PANDAW				



MANAGED BY AYRAVATA CRUISE COMPANY



MANAGED BY AYRAVATA CRUISE COMPANY

MYANMAR DAYS - THE BHAMO CRUISE

7 NIGHTS - DEPARTURE DAY: MONDAY

CODE	DEP DATE	ARR DATE	VESSEL	CODE	DEP DATE	ARR DATE	VESSEL
BM00112	24/10/11	31/10/11	PANDAW	BM00212	31/10/11	07/11/11	PANDAW

THE ROYAL CAPITALS (NEW)

5 NIGHTS

UPSTREAM

CODE	DEP DATE	ARR DATE	VESSEL	CODE	DEP DATE	ARR DATE	VESSEL
RC08U12	23/11/11	28/11/11	PANDAW	RC12U12	15/02/12	20/02/12	PANDAW
RC09U12	14/12/11	19/12/11	PANDAW	RC13U12	07/03/12	12/03/12	PANDAW
RC10U12	04/01/12	09/01/12	PANDAW	RC14U12	28/03/12	02/04/12	PANDAW
RC11U12	25/01/12	30/01/12	PANDAW				

DOWNSTREAM

CODE	DEP DATE	ARR DATE	VESSEL	CODE	DEP DATE	ARR DATE	VESSEL
RC08D12	07/11/11	12/11/11	PANDAW	RC12D12	30/01/12	04/02/12	PANDAW
RC09D12	28/11/11	03/12/11	PANDAW	RC13D12	20/02/12	25/02/12	PANDAW
RC10D12	19/12/11	24/12/11	PANDAW	RC14D12	12/03/12	17/03/12	PANDAW
RC11D12	09/01/12	14/01/12	PANDAW				

(*) If deemed necessary, Company reserves the right at its sole option and discretion, without any liability for damages or refund to substitute the scheduled vessel with another equivalent of its fleet.



MANAGED BY AYRAVATA CRUISE COMPANY

SORTED BY DATES

ALL CRUISES

CRUISE	ROUTE	DEP DATE	ARR DATE	VESSEL	CODE
Grand Voyage of The Chindwin River(9N)	Upstream	20/09/11	29/09/11	PANDAW	TGV00112
From Royal Mandalay To Ancient Bagan (2N)	Downstream	16/10/11	18/10/11	PAUKAN	MB012PK12
Between Ancient Bagan and Royal Mandalay(2N)	Upstream	18/10/11	20/10/11	PAUKAN	BM012PK12
Between Royal Mandalay and Ancient Bagan (1N)	Downstream	20/10/11	21/10/11	PAUKAN	MB011PK12
Between Ancient Bagan And Royal Mandalay(2N)	Upstream	21/10/11	23/10/11	PAUKAN	BM022PK12
From Royal Mandalay To Ancient Bagan (2N)	Downstream	23/10/11	25/10/11	PAUKAN	MB022PK12
Myanmar Days “ The Bhamo Cruise”(7N)	Downstream	24/10/11	31/10/11	PANDAW	BM00112
Between Ancient Bagan And Royal Mandalay(2N)	Upstream	25/10/11	27/10/11	PAUKAN	BM032PK12
Between Royal Mandalay and Ancient Bagan (1N)	Downstream	27/10/11	28/10/11	PAUKAN	MB021PK12
Between Ancient Bagan And Royal Mandalay(2N)	Upstream	28/10/11	30/10/11	PAUKAN	BM042PK12
From Royal Mandalay To Ancient Bagan (2N)	Downstream	30/10/11	01/11/11	PAUKAN	MB032PK12
Myanmar Days “ The Bhamo Cruise”(7N)	Downstream	31/10/11	07/11/11	PANDAW	BM00212
Between Ancient Bagan And Royal Mandalay(2N)	Upstream	01/11/11	03/11/11	PAUKAN	BM052PK12
Between Royal Mandalay and Ancient Bagan (1N)	Downstream	03/11/11	04/11/11	PAUKAN	MB031PK12
Between Ancient Bagan And Royal Mandalay(2N)	Upstream	04/11/11	06/11/11	PAUKAN	BM062PK12
From Royal Mandalay To Ancient Bagan (2N)	Downstream	06/11/11	08/11/11	PAUKAN	MB042PK12
Golden Myanmar (10N)	Downstream	07/11/11	17/11/11	PANDAW	GM08D12
The Royal Capitals(5N)	Downstream	07/11/11	12/11/11	PANDAW	RC08D12
Between Ancient Bagan And Royal Mandalay(2N)	Upstream	08/11/11	10/11/11	PAUKAN	BM072PK12
Between Royal Mandalay and Ancient Bagan (1N)	Downstream	10/11/11	11/11/11	PAUKAN	MB041PK12
Between Ancient Bagan And Royal Mandalay(2N)	Upstream	11/11/11	13/11/11	PAUKAN	BM082PK12
From Royal Mandalay To Ancient Bagan (2N)	Downstream	13/11/11	15/11/11	PAUKAN	MB052PK12
Between Ancient Bagan And Royal Mandalay(2N)	Upstream	15/11/11	17/11/11	PAUKAN	BM092PK12
Between Royal Mandalay and Ancient Bagan (1N)	Downstream	17/11/11	18/11/11	PAUKAN	MB051PK12
Between Ancient Bagan And Royal Mandalay(2N)	Upstream	18/11/11	20/11/11	PAUKAN	BM102PK12
Golden Myanmar (10N)	Upstream	18/11/11	28/11/11	PANDAW	GM08U12
From Royal Mandalay To Ancient Bagan (2N)	Downstream	20/11/11	22/11/11	PAUKAN	MB062PK12
Between Ancient Bagan And Royal Mandalay(2N)	Upstream	22/11/11	24/11/11	PAUKAN	BM112PK12



MANAGED BY AYRAVATA CRUISE COMPANY

The Royal Capitals (5N)	Upstream	23/11/11	28/11/11	PANDAW	RC08U12
Between Royal Mandalay and Ancient Bagan (1N)	Downstream	24/11/11	25/11/11	PAUKAN	MB061PK12
Between Ancient Bagan And Royal Mandalay(2N)	Upstream	25/11/11	27/11/11	PAUKAN	BM122PK12
From Royal Mandalay To Ancient Bagan (2N)	Downstream	27/11/11	29/11/11	PAUKAN	MB072PK12
Golden Myanmar (10N)	Downstream	28/11/11	08/12/11	PANDAW	GM09D12
The Royal Capitals(5N)	Downstream	28/11/11	03/12/11	PANDAW	RC09D12
Between Ancient Bagan And Royal Mandalay(2N)	Upstream	29/11/11	01/12/11	PAUKAN	BM132PK12
Between Royal Mandalay and Ancient Bagan (1N)	Downstream	01/12/11	02/12/11	PAUKAN	MB071PK12
Between Ancient Bagan And Royal Mandalay(2N)	Upstream	02/12/11	04/12/11	PAUKAN	BM142PK12
From Royal Mandalay To Ancient Bagan (2N)	Downstream	04/12/11	06/12/11	PAUKAN	MB082PK12
Between Ancient Bagan And Royal Mandalay(2N)	Upstream	06/12/11	08/12/11	PAUKAN	BM152PK12
Between Royal Mandalay and Ancient Bagan (1N)	Downstream	08/12/11	09/12/11	PAUKAN	MB081PK12
Between Ancient Bagan And Royal Mandalay(2N)	Upstream	09/12/11	11/12/11	PAUKAN	BM162PK12
Golden Myanmar (10N)	Upstream	09/12/11	19/12/11	PANDAW	GM09U12
From Royal Mandalay To Ancient Bagan (2N)	Downstream	11/12/11	13/12/11	PAUKAN	MB092PK12
Between Ancient Bagan And Royal Mandalay(2N)	Upstream	13/12/11	15/12/11	PAUKAN	BM172PK12
The Royal Capitals(5N)	Upstream	14/12/11	19/12/11	PANDAW	RC09U12
Between Royal Mandalay and Ancient Bagan (1N)	Downstream	15/12/11	16/12/11	PAUKAN	MB091PK12
Between Ancient Bagan And Royal Mandalay(2N)	Upstream	16/12/11	18/12/11	PAUKAN	BM182PK12
From Royal Mandalay To Ancient Bagan (2N)	Downstream	18/12/11	20/12/11	PAUKAN	MB102PK12
Golden Myanmar (10N)	Downstream	19/12/11	29/12/11	PANDAW	GM10D12
The Royal Capitals(5N)	Downstream	19/12/11	24/12/11	PANDAW	RC10D12
Between Ancient Bagan And Royal Mandalay(2N)	Upstream	20/12/11	22/12/11	PAUKAN	BM192PK12
Between Royal Mandalay and Ancient Bagan (1N)	Downstream	22/12/11	23/12/11	PAUKAN	MB101PK12
Between Ancient Bagan And Royal Mandalay(2N)	Upstream	23/12/11	24/12/11	PAUKAN	BM202PK12
From Royal Mandalay To Ancient Bagan (2N)	Downstream	25/12/11	27/12/11	PAUKAN	MB112PK12
Between Ancient Bagan And Royal Mandalay(2N)	Upstream	27/12/11	29/12/11	PAUKAN	BM212PK12
Between Royal Mandalay and Ancient Bagan (1N)	Downstream	29/12/11	30/12/11	PAUKAN	MB111PK12
Between Ancient Bagan And Royal Mandalay(2N)	Upstream	30/12/11	01/01/12	PAUKAN	BM222PK12
Golden Myanmar (10N)	Upstream	30/12/11	09/01/12	PANDAW	GM10U12
From Royal Mandalay To Ancient Bagan (2N)	Downstream	01/01/12	03/01/12	PAUKAN	MB122PK12



MANAGED BY AYRAVATA CRUISE COMPANY

Between Ancient Bagan And Royal Mandalay(2N)	Upstream	03/01/12	05/01/12	PAUKAN	BM232PK12
The Royal Capitals(5N)	Upstream	04/01/12	09/01/12	PANDAW	RC10U12
Between Royal Mandalay and Ancient Bagan (1N)	Downstream	05/01/12	06/01/12	PAUKAN	MB121PK12
Between Ancient Bagan And Royal Mandalay(2N)	Upstream	06/01/12	08/01/12	PAUKAN	BM242PK12
From Royal Mandalay To Ancient Bagan (2N)	Downstream	08/01/12	10/01/12	PAUKAN	MB132PK12
Golden Myanmar (10N)	Downstream	09/01/12	19/01/12	PANDAW	GM11D12
The Royal Capitals(5N)	Downstream	09/01/12	14/01/12	PANDAW	RC11D12
Between Ancient Bagan And Royal Mandalay(2N)	Upstream	10/01/12	12/01/12	PAUKAN	BM252PK12
Between Royal Mandalay and Ancient Bagan (1N)	Downstream	12/01/12	13/01/12	PAUKAN	MB131PK12
Between Ancient Bagan And Royal Mandalay(2N)	Upstream	13/01/12	15/01/12	PAUKAN	BM262PK12
From Royal Mandalay To Ancient Bagan (2N)	Downstream	15/01/12	17/01/12	PAUKAN	MB142PK12
Between Ancient Bagan And Royal Mandalay(2N)	Upstream	17/01/12	19/01/12	PAUKAN	BM272PK12
Between Royal Mandalay and Ancient Bagan (1N)	Downstream	19/01/12	20/01/12	PAUKAN	MB141PK12
Between Ancient Bagan And Royal Mandalay(2N)	Upstream	20/01/12	22/01/12	PAUKAN	BM282PK12
Golden Myanmar (10N)	Upstream	20/01/12	30/01/12	PANDAW	GM11U12
From Royal Mandalay To Ancient Bagan (2N)	Downstream	22/01/12	24/01/12	PAUKAN	MB152PK12
Between Ancient Bagan And Royal Mandalay(2N)	Upstream	24/01/12	26/01/12	PAUKAN	BM292PK12
The Royal Capitals(5N)	Upstream	25/01/12	30/01/12	PANDAW	RC11U12
Between Royal Mandalay and Ancient Bagan (1N)	Downstream	26/01/12	27/01/12	PAUKAN	MB151PK12
Between Ancient Bagan And Royal Mandalay(2N)	Upstream	27/01/12	29/01/12	PAUKAN	BM302PK12
From Royal Mandalay To Ancient Bagan (2N)	Downstream	29/01/12	31/01/12	PAUKAN	MB162PK12
Golden Myanmar (10N)	Downstream	30/01/12	09/02/12	PANDAW	GM12D12
The Royal Capitals(5N)	Downstream	30/01/12	04/02/12	PANDAW	RC12D12
Between Ancient Bagan And Royal Mandalay(2N)	Upstream	31/01/12	02/02/12	PAUKAN	BM312PK12
Between Royal Mandalay and Ancient Bagan (1N)	Downstream	02/02/12	03/02/12	PAUKAN	MB161PK12
Between Ancient Bagan And Royal Mandalay(2N)	Upstream	03/02/12	05/02/12	PAUKAN	BM322PK12
From Royal Mandalay To Ancient Bagan (2N)	Downstream	05/02/12	07/02/12	PAUKAN	MB172PK12
Between Ancient Bagan And Royal Mandalay(2N)	Upstream	07/02/12	09/02/12	PAUKAN	BM332PK12
Between Royal Mandalay and Ancient Bagan (1N)	Downstream	09/02/12	10/02/12	PAUKAN	MB171PK12
Between Ancient Bagan And Royal Mandalay(2N)	Upstream	10/02/12	12/02/12	PAUKAN	BM342PK12
Golden Myanmar (10N)	Upstream	10/02/12	20/02/12	PANDAW	GM12U12



MANAGED BY AYRAVATA CRUISE COMPANY

From Royal Mandalay To Ancient Bagan (2N)	Downstream	12/02/12	14/02/12	PAUKAN	MB182PK12
Between Ancient Bagan And Royal Mandalay(2N)	Upstream	14/02/12	16/02/12	PAUKAN	BM352PK12
The Royal Capitals(5N)	Upstream	15/02/12	20/02/12	PANDAW	RC12U12
Between Royal Mandalay and Ancient Bagan (1N)	Downstream	16/02/12	17/02/12	PAUKAN	MB181PK12
Between Ancient Bagan And Royal Mandalay(2N)	Upstream	17/02/12	19/02/12	PAUKAN	BM362PK12
From Royal Mandalay To Ancient Bagan (2N)	Downstream	19/02/12	21/02/12	PAUKAN	MB192PK12
Golden Myanmar (10N)	Downstream	20/02/12	01/03/12	PANDAW	GM13D12
The Royal Capitals(5N)	Downstream	20/02/12	25/02/12	PANDAW	RC13D12
Between Ancient Bagan And Royal Mandalay(2N)	Upstream	21/02/12	23/02/12	PAUKAN	BM372PK12
Between Royal Mandalay and Ancient Bagan (1N)	Downstream	23/02/12	24/02/12	PAUKAN	MB191PK12
Between Ancient Bagan And Royal Mandalay(2N)	Upstream	24/02/12	26/02/12	PAUKAN	BM382PK12
From Royal Mandalay To Ancient Bagan (2N)	Downstream	26/02/12	28/02/12	PAUKAN	MB202PK12
Between Ancient Bagan And Royal Mandalay(2N)	Upstream	28/02/12	01/03/12	PAUKAN	BM392PK12
Between Royal Mandalay and Ancient Bagan (1N)	Downstream	01/03/12	02/03/12	PAUKAN	MB201PK12
Between Ancient Bagan And Royal Mandalay(2N)	Upstream	02/03/12	04/03/12	PAUKAN	BM402PK12
Golden Myanmar (10N)	Upstream	02/03/12	12/03/12	PANDAW	GM13U12
From Royal Mandalay To Ancient Bagan (2N)	Downstream	04/03/12	06/03/12	PAUKAN	MB212PK12
Between Ancient Bagan And Royal Mandalay(2N)	Upstream	06/03/12	08/03/12	PAUKAN	BM412PK12
The Royal Capitals(5N)	Upstream	07/03/12	12/03/12	PANDAW	RC13U12
Between Royal Mandalay and Ancient Bagan (1N)	Downstream	08/03/12	09/03/12	PAUKAN	MB211PK12
Between Ancient Bagan And Royal Mandalay(2N)	Upstream	09/03/12	11/03/12	PAUKAN	BM422PK12
From Royal Mandalay To Ancient Bagan (2N)	Downstream	11/03/12	13/03/12	PAUKAN	MB222PK12
Golden Myanmar (10N)	Downstream	12/03/12	22/03/12	PANDAW	GM14D12
The Royal Capitals(5N)	Downstream	12/03/12	17/03/12	PANDAW	RC14D12
Between Ancient Bagan And Royal Mandalay(2N)	Upstream	13/03/12	15/03/12	PAUKAN	BM432PK12
Between Royal Mandalay and Ancient Bagan (1N)	Downstream	15/03/12	16/03/12	PAUKAN	MB221PK12
Between Ancient Bagan And Royal Mandalay(2N)	Upstream	16/03/12	18/03/12	PAUKAN	BM442PK12
From Royal Mandalay To Ancient Bagan (2N)	Downstream	18/03/12	20/03/12	PAUKAN	MB232PK12
Between Ancient Bagan And Royal Mandalay(2N)	Upstream	20/03/12	22/03/12	PAUKAN	BM452PK12
Between Royal Mandalay and Ancient Bagan (1N)	Downstream	22/03/12	23/03/12	PAUKAN	MB231PK12
Between Ancient Bagan And Royal Mandalay(2N)	Upstream	23/03/12	25/03/12	PAUKAN	BM462PK12



MANAGED BY AYRAVATA CRUISE COMPANY

Golden Myanmar (10N)	Upstream	23/03/12	02/04/12	PANDAW	GM14U12
From Royal Mandalay To Ancient Bagan (2N)	Downstream	25/03/12	27/03/12	PAUKAN	MB242PK12
Between Ancient Bagan And Royal Mandalay(2N)	Upstream	27/03/12	29/03/12	PAUKAN	BM472PK12
The Royal Capitals(5N)	Upstream	28/03/12	02/04/12	PANDAW	RC14U12
Between Royal Mandalay and Ancient Bagan (1N)	Downstream	29/03/12	30/03/12	PAUKAN	MB241PK12
Between Ancient Bagan And Royal Mandalay(2N)	Upstream	30/03/12	01/04/12	PAUKAN	BM482PK12
From Royal Mandalay To Ancient Bagan (2N)	Downstream	01/04/12	03/04/12	PAUKAN	MB252PK12
Between Ancient Bagan And Royal Mandalay(2N)	Upstream	03/04/12	05/04/12	PAUKAN	BM492PK12
Between Royal Mandalay and Ancient Bagan (1N)	Downstream	05/04/12	06/04/12	PAUKAN	MB251PK12
Between Ancient Bagan And Royal Mandalay(2N)	Upstream	06/04/12	08/04/12	PAUKAN	BM502PK12
From Royal Mandalay To Ancient Bagan (2N)	Downstream	08/04/12	10/04/12	PAUKAN	MB262PK12
Between Ancient Bagan And Royal Mandalay(2N)	Upstream	10/04/12	12/04/12	PAUKAN	BM512PK12
Between Royal Mandalay and Ancient Bagan (1N)	Downstream	12/04/12	13/04/12	PAUKAN	MB261PK12
Between Ancient Bagan And Royal Mandalay(2N)	Upstream	13/04/12	15/04/12	PAUKAN	BM522PK12
From Royal Mandalay To Ancient Bagan (2N)	Downstream	15/04/12	17/04/12	PAUKAN	MB272PK12
Between Ancient Bagan And Royal Mandalay(2N)	Upstream	17/04/12	19/04/12	PAUKAN	BM532PK12
Between Royal Mandalay and Ancient Bagan (1N)	Downstream	19/04/12	20/04/12	PAUKAN	MB271PK12
Between Ancient Bagan And Royal Mandalay(2N)	Upstream	20/04/12	22/04/12	PAUKAN	BM542PK12
From Royal Mandalay To Ancient Bagan (2N)	Downstream	22/04/12	24/04/12	PAUKAN	MB282PK12
Between Ancient Bagan And Royal Mandalay(2N)	Upstream	24/04/12	26/04/12	PAUKAN	BM552PK12
Between Royal Mandalay and Ancient Bagan (1N)	Downstream	26/04/12	27/04/12	PAUKAN	MB281PK12
Between Ancient Bagan And Royal Mandalay(2N)	Upstream	27/04/12	29/04/12	PAUKAN	BM562PK12
From Royal Mandalay To Ancient Bagan (2N)	Downstream	29/04/12	01/05/12	PAUKAN	MB292PK12

(*) If deemed necessary, Company reserves the right at its sole option and discretion, without any liability for damages or refund to substitute the scheduled vessel with another equivalent of its fleet.



MANAGED BY AYRAVATA CRUISE COMPANY

SALES TERMS AND CONDITIONS FOR PASSENGERS

RATES

- The Cruises Retail Rates are per person in US\$ based on two pax sharing a cabin.
- The Cruises Retail Rates are based on known costs (including Fuel Costs and Governmental Taxes/fees) as for 01 April 2010.
- The Cruises Retail Rates are guaranteed within the validity of the same but the company reserves the right to apply a surcharge (up to 30 days before the departure) in the sole case of an increase in Governmental Tax/Fees and/or Fuel Costs. Such surcharge is applicable to any bookings where the full balance has not been paid yet.

LAND TOUR RATES

All rates in US Dollar at current rates of exchange and are subject to change without prior notice.

CHILDREN POLICY

RV PAUKAN (2007)

- Up to 2 years: Complimentary in the parent/guardian's cabin.
- 3-12 Years: if the child stays in the cabin with one of the parents/guardians 50% of the twin-sharing rate. Upon request we can provide an Extra Bed.
- Suite rooms: Complimentary up to 12 years old (cot or extra bed is provided).

RV PANDAW (1947)

- Up to 2 years: Complimentary in the parent/guardian's cabin.
- 3-12 Years: if the child stays in the bed with one of the parents/guardians 50% of the twin-sharing rate.



MANAGED BY AYRAVATA CRUISE COMPANY

RESERVATION POLICIES & PAYMENT TERMS

ENQUIRES / RESERVATION

E-mail: info@ayravatacruises.com

Fax: +95 1 382734

BOOKING PROCEDURES

- Option Terms: we can hold your request of cabins for up to 7 days.
- Reconfirmation: In order to reconfirm your reservation, we kindly require your written confirmation (the signed copy) of the "Option" Pro forma invoice not later than 8 days of the issuing date with the acceptance of the "Booking Terms and Conditions" (by fax or e-mail) stating guest names, Passport-Visa Number, DOB, Arrival Date in Myanmar, Arrival Flight.
- Invoice: After receiving your reconfirmation, we will send you a "Confirmation" Final Invoice. Payment can be done either by Bank Transfer or Credit Card (subject to bank approval).
- Deposit: To secure the reservation, 20% deposit (not refundable) is required upon reconfirmation. If the booking is made less than 61 days prior the departure we require to settle the full amount of the holiday price.

CANCELLATION TERMS

The cancellation notice must be received in writing either by e-mail or fax. It will be effective on the date of receipt. Cancellation charges, per person, are based upon the date of cancellation:

- Up to 91 days prior to departure: Deposit will be forfeited.
- From 90-61: 30% of Holiday Price
- From 60-31: 50% of Holiday Price
- From 30 days to "no show" 100% of Holiday Price

DEPARTURE DATE CHANGE / REVISION

- Up to 91 days prior to departure all type of changes are subject to US\$30 charge per change
- From 90 days prior to departure any departure date changes is subject to a Cancellation Fee as stated above.

PAYMENT TERMS

- In order to secure your reservation, 20% deposit (not refundable) is required upon booking confirmation
- Final balance: within 60 days prior the departure date.
- Payment can be done either by Bank Transfer or Credit Card (subject to bank approval)



MANAGED BY AYRAVATA CRUISE COMPANY

ADDITIONAL TERMS

MINIMUM OCCUPANCY

For all departures should the occupancy be less than 10 passengers for **Short Discovery Cruise** and 12 passengers for **Exploration and Discovery Cruises** the Company reserves the right to cancel the cruise up to 60 days prior the departure date. A confirmation notice in writing will be released by the company to all booked clients and/or their agents within the deadline. In case of cancellation an alternative cruise will be offered and if not acceptable all down payments will be immediately refunded.

OPERATING VESSEL

Ayravata Cruises reserves the right at its sole option and discretion, without any liability for damages or refund, of any kind to arrange for substantially equivalent transportation by another vessel, whether belonging to the Company or not.

LAND TOURS

LIABILITY

Land Tours are operated by third parties. Ayravata Cruises acts as coordinator, supervisor and agent only and is therefore not responsible for any loss, injury or damage sustained by the tourists, including those occurring outside the touring programs.

PASSENGER INFORMATION

Information regarding “life on board” and safety procedures can be found in the links below. A PDF version in 4 languages is available upon request. We strongly recommend all agents and passengers to read it before travelling.

RV PAUKAN

<http://www.ayravatacruises.com/passenger-info-pk.htm>

RV PANDAW1947

<http://www.ayravatacruises.com/passenger-info-pd.htm>



MANAGED BY AYRAVATA CRUISE COMPANY

PASSENGER TICKET CONTRACT

IMPORTANT TERMS AND CONDITIONS OF THIS PASSENGER TICKET CONTRACT (the “Contract”) ARE CONTAINED BELOW.

PASSENGER HEREBY ACCEPTS AND AGREES TO THE TERMS AND CONDITIONS CONTAINED IN THIS CONTRACT.

IMPORTANT NOTICE TO PASSENGERS: THIS CONTRACT IS A LEGALLY BINDING CONTRACT BETWEEN PASSENGER AND COMPANY. THIS CONTRACT CONTAINS CERTAIN LIMITATIONS OF LIABILITY, INCLUDING LIMITATIONS RESPECTING INJURY TO OR DEATH OF PASSENGER AND DAMAGE CLAIMS RELATING TO BAGGAGE. CERTAIN OTHER PERSONS AND ENTITIES, AS WELL AS THE VESSEL ITSELF, ARE ALSO GRANTED RIGHTS UNDER THIS TICKET CONTRACT. PLEASE READ THESE TERMS AND CONDITIONS CAREFULLY. BY ACCEPTING THIS CONTRACT AND BOARDING THE VESSEL, PASSENGER AGREES TO ACCEPT AND TO BE BOUND BY ALL OF THE TERMS AND CONDITIONS HEREOF, INCLUDING SPECIFICALLY THOSE REGARDING PASSENGER’S RIGHT TO SUE, GOVERNING LAW, FORUM AND JURISDICTION.

NOTICE: SECTIONS 4, 5, 6, 7, 8, 9, 10 and 12 CONTAIN IMPORTANT LIMITATIONS ON PASSENGER’S RIGHT TO ASSERT CLAIMS AGAINST COMPANY AND CERTAIN THIRD PARTIES.

TERMS AND CONDITIONS OF THIS CONTRACT

THE FOLLOWING TERMS AND CONDITIONS ARE THE ENTIRE AGREEMENT BETWEEN COMPANY AND PASSENGER. THIS IS A BINDING CONTRACT. Company enters into contracts of carriage, issues all Contracts, and accepts and carries Passenger and Baggage only on and subject to these Terms and Conditions. This Contract is an agreement between Passenger and Company, and their respective agents, servants and employees. Specifically, the limitations of liability contained herein are applicable to claims against all parties listed in the definition of “Company”.

1. DEFINITIONS:

“**Baggage**” means all such Passenger baggage allowed on the Vessel pursuant to the terms of this Contract which is placed in Passenger’s cabin, or which has been stored in the Vessel’s baggage room, holds or safe against receipt therefore at the request of Passenger.

“**Company**” means Ayravata Cruises (Interconnection Co. Ltd), and its and their owners, operators and charterers, all affiliated companies including but not limited to, parent and or subsidiary entities and sales representatives and all employees of such individuals and companies.

“**Conventions**” means the Athens Convention Relating to the Carriage of Passengers and Their Luggage by Sea, 1974, the International Convention on Limitation of Liability For Maritime Claims, 1976, and, where applicable, the Strasbourg Convention on the Limitation of Liability in Inland Navigation, 1988.

“**Passenger**” means every person named on the face of this Contract and/or traveling under this Contract or occupying the cabin designated on this Contract, including their heirs, successors in interest and personal representatives.

“**Contract**” means this entire Passenger Ticket Contract document including all its terms and conditions.

“**Vessel**” means any ship chartered or operated or provided by Company, whether owned, chartered, or operated by Company or by third parties; on which Passenger may be traveling, or any ship substituted therefore, and its tenders or any other similar means of conveyance.



MANAGED BY AYRAVATA CRUISE COMPANY

2. NON-TRANSFERABILITY/BINDING EFFECT: This Contract is valid only for Passenger or Passengers named herein for the date and Vessel indicated. It may not be sold or transferred. Passenger represents and warrants that s/he is duly authorized by and on behalf of all Passengers (including minor children) named on this Contract to agree to and to bind all such Passengers to such terms and conditions.

3. EMBARKATION: Passenger is required to be on board the Vessel at least 30 minutes before the initial scheduled departure time and any departure time subsequently announced during the cruise. At the time of embarkation Passenger is responsible for having received all medical inoculations necessary for the voyage. Company shall have no liability to Passenger whatsoever if Passenger is not on board prior to the Vessel's departure.

4. BAGGAGE, VALUABLES AND OTHER POSSESSIONS: All Baggage must be securely packed and distinctly labeled with Passenger's full name, the name of the Vessel, and the cabin number of Passenger and the sailing date of the Vessel. Under no circumstances, may dangerous articles such as firearms, explosives, oxygen or combustible substances, alcohol, drugs, illegal substances, or dangerous goods be taken aboard the Vessel. Any such item shall be surrendered to the Captain of the Vessel at embarkation, and may be disposed of in the sole discretion of the Captain.

Hand or unlocked luggage, breakables and valuables, including but not limited to jewelry, money, precious stones, securities, financial instruments and/or tickets, must be hand-carried by Passengers on and off the Vessel. Company shall not be responsible for loss or damage to such items.

5. LIABILITY LIMITATIONS FOR LOSS OF AND/OR DAMAGE TO PROPERTY: The total value of the Baggage, valuables and other personal belongings of a Passenger aboard the Vessel who does not deposit valuables for safekeeping, as described in this Contract, shall be deemed not to exceed the amount of US\$200 per Passenger and Company's liability, if any, for loss of or damage to such belongings is limited to a maximum of US\$200 per Passenger. Company provides safekeeping for valuables aboard the Vessel and encourages Passengers to deposit any jewelry or other valuables brought aboard the Vessel with the designated officer who will issue a receipt for such valuables. Company shall not be liable for any loss of or damage to money, jewelry, precious stones, securities, financial instruments, tickets or other valuables unless they have been delivered to the Ship Manager and a receipt issued. The value of articles delivered for safekeeping shall be deemed not to exceed US\$200 unless Company agrees in writing to a higher value for the articles at the time of delivery to the Ship Manager.

Unless specifically provided elsewhere in this Contract, Company shall have no liability for loss or damage to Baggage or personal effects. Personal belongings lost while unattended in public lounges or other public areas, whether on board the Vessel or elsewhere, are not reimbursable. Losses due to ordinary wear and tear, perils of the river, and other acts-of-God are not reimbursable. Settlements of reimbursable claims for lost belongings will be made on the basis of actual cash value (replacement cost less depreciation). Settlements of reimbursable claims for damaged items will be on the basis of cost of repair or actual cash value, whichever is less. No amount shall be paid in settlement of any claim without proof of the actual cash value or repair cost as appropriate arising from the loss or damage. Such proof must be sent to Company. Company liability must be proven before any settlement will be paid.

6. ITINERARY / RIGHT TO CHANGE / DETENTION: Company will make every reasonable effort to undertake the advertised and any other agreed and offered sailings but no sailings are guaranteed and sailings may be altered, delayed, amended, or cancelled subject to circumstances. If the performance of the proposed voyage is hindered or prevented (or in the opinion of Company is likely to be hindered or prevented) by high or low water levels, docking difficulties, weather condition, breakdown of the Vessel, congestion, lock operational malfunction, or any other cause whatsoever or if Company considers that for any reason whatsoever, proceeding to, attempting to enter, or entering or remaining at the place of



MANAGED BY AYRAVATA CRUISE COMPANY

disembarkation may expose the Vessel to risk of loss or damage or to be likely to delay her, Passenger and his property may be landed at any place which Company or the Captain of the Vessel in his or her discretion may reasonably decide upon, at which place the responsibility of Company shall cease and this contract shall be deemed to have been fully performed, or if Passenger has not embarked, Company may cancel the proposed voyage and shall refund Passenger money or fares paid in advance. Company reserves the right at its sole option and discretion, without any liability for damages or refund, of any kind to deviate from the Vessel's advertised or ordinary itinerary or route, to delay, advance or lengthen any sailing, to omit or change ports of call, to arrange for substantially equivalent transportation by another vessel and/or by other means of transportation, including without limitation by coach or other land transportation alternatives, whether belonging to Company or not, and to cause Passenger to disembark from the Vessel temporarily or permanently. Company may for any reason whatsoever cancel any sailing or terminate the Contract at any time before departure of the Vessel, and in such event, Company's only liability will be to refund to Passenger the amount it has received for the Contract. For purposes of assisting other vessels or protecting life or property, the Captain of the Vessel has the right, at his or her sole discretion, to deviate from the Vessel's advertised or ordinary itinerary or route, to delay, advance or cancel any sailing, to omit or change any ports of call, to tow or to be towed, to transfer Passenger and Passenger's baggage to any other vessel and or other means of transportation whether belonging to Company or not, cause Passenger to disembark the Vessel temporarily or permanently, and Passenger shall have no claims against Company in such circumstances.

7. HEALTH AND SECURITY/INDEMNIFICATION BY PASSENGER: Access to the ship at certain river stations can be difficult, with steep and sometimes slippery river banks. Passenger represents and warrants that Passenger is physically and otherwise fit to travel; that s/he will at all times comply with Vessel's rules and regulations and orders and directions of the Vessel's officers and staff; that his/her conduct will not impair the safety of the Vessel or inconvenience other passengers.

Company and the Captain of the Vessel, without liability, at any time, may refuse to transport or may land any Passenger at any port or place, or transfer Passenger to other means of transportation, because of health or physical condition, mental disorder, failure to abide by Vessel regulations or other causes rendering Passenger unfit to travel on the Vessel.

If Passenger is refused passage or leaves the Vessel prior to the end of the cruise for any of the reasons described in this section or for other reasons including, but not limited to, personal, medical, or business reasons, Company will not be required to refund any portion of the Contract price, or be responsible for any of Passenger's cost.

Passenger hereby consents to a reasonable search being made of Passenger's person, baggage or other property, and to the removal and confiscation or destruction of any object which may, in the opinion of Company, impair the safety of the Vessel or inconvenience other Passengers.

Passenger shall indemnify Company for all penalties, fines, charges, losses or expenses incurred or imposed upon Company or the Vessel by virtue of any act or violation of law by Passenger.

8. PASSENGER RESTRICTIONS: Company does not discriminate against persons on the basis of disability. Company is unable to accommodate women past their sixth month of pregnancy and children less than six months of age. Company may limit the number of Passengers less than three years of age aboard the Vessel. Any child under the age of eighteen must be accompanied by an adult over the age of twenty-one. If the accompanying adult is not a parent, a "Parental Consent Guardianship Form" must be signed by a parent or legal guardian of the child and received by Company prior sailing. Passenger is required to advise Company in writing, at or prior to the time a cruise is booked, of any physical, emotional or mental condition which may require professional attention during the cruise. The Vessel is not able to accommodate wheelchairs. Passengers with mobility impairments must be accompanied by someone who is able to assist



MANAGED BY AYRAVATA CRUISE COMPANY

Passenger, on shore and on board the Vessel, and is responsible for providing Passenger all necessary aid and facilities. If any such condition arises after the cruise is booked, Passenger is required to advise Company in writing immediately. Company and all personnel aboard the Vessel shall have no liability to Passenger relating to such condition or its treatment.

9. INDEPENDENT CONTRACTOR/SHORE TOURS/LIMIT OF LIABILITY: Company makes no representations concerning and has no responsibility for tours, including, without limitation, shore excursions, hotels, restaurants and transportation, whether by vessel, air, rail, land or other means, not owned or operated by Company. Company shall have no obligation or liability of any kind to Passenger for acts or omissions in connection with or arising out of arrangements with independent contractors. Arrangements with independent contractors include, but are not limited to the following: (1) airline and surface transportation; (2) services or products available for Passenger's convenience aboard the Vessel; (2) services, products or transportation provided other than aboard the Vessel furnished by others, including without limitation, sight-seeing tours, pre-cruise and post-cruise tours, excursions, shore trips and tender service, whether arranged or organized by tour operators, travel agents or Company. The Passenger's agreements with independent contractors are not covered by this Contract and shall be subject to the terms and conditions of Passenger's agreements with such carriers and independent contractors, whether or not any products sold, services tendered or transportation provided to Passenger is arranged directly or through Company. Passenger agrees that all rights, exemptions from liability, defenses and immunities of whatsoever nature referred to in this Contract applicable to Company or the Vessel, shall in all respects inure also for the benefit of any servant, agent or independent contractor of Company acting in the course of or in connection with their employment so that in no circumstances shall any such servant, agent or independent contractor, as the result of so acting, be under any liability to any such Passenger different from that of Company.

10. NO LIABILITY FOR MEDICAL TREATMENT: No staff doctors or nurses are employed by Company on the Vessel. If Passenger requires medical attention during the trip, medical services will be provided at local facilities. Passenger shall be responsible for all costs and expenses of medical services, treatment and medications. Company shall have no liability whatsoever for any costs incurred in connection with medical services, or for the quality of care Passenger receives. Passenger consents to treatment by medical professionals designated by Company, if Passenger is unable to request or authorize medical treatment and, in the opinion of the Ship Manager, medical attention is necessary, solely at the expense of Passenger and without liability to Company.

11. PAYMENT BY PASSENGER AND EXTRA EXPENSES: Any and all payments by Passenger to Company shall be made in currency of the United States of America or such other currency acceptable to Company. All charges for services and products provided on board the Vessel must be settled in cash or charged (via credit card acceptable to Company) before Passenger's final disembarkation from the Vessel. Any other expenses incurred by Passenger or by Company on behalf of Passenger shall be payable by Passenger on demand.

12. LIABILITY LIMITATION FOR LOSS OF LIFE OR BODILY INJURY: If Passenger is injured, becomes ill, or dies, or Passenger's property is lost or damaged, or Passenger and/or his/her property is delayed, Company will not be liable to Passenger for any damages unless the occurrence was due to the negligence of Company or willful fault. Company disclaims liability to Passenger under any circumstances for infliction of emotional distress, mental suffering or psychological injury which was not: (i) the result of physical injury to Passenger caused by the negligence or fault of a crewmember or the manager, agent, master, owner or operator of the Vessel; (ii) the result of Passenger having been at actual risk of physical injury, and such risk was caused by the negligence or fault of a crewmember or the manager, agent, master, owner or operator of the Vessel; or (iii) intentionally inflicted by a crewmember or the manager, agent, master, owner or operator of the Vessel. In no event will Company be liable to Passenger for consequential, incidental, exemplary or punitive damages.



MANAGED BY AYRAVATA CRUISE COMPANY

In addition to all of the restrictions and exemptions from liability provided in this Contract, the liability of Company for the death of or personal injury (including emotional distress or injury) to a Passenger shall in no event exceed the monetary limitations set forth in Article 7 of the Athens Convention. Nothing in this Contract is intended nor shall operate to limit or deprive Company of any such statutory limitation of or exoneration from liability, or of the benefits of any statute or law of any country which might be applicable providing for exoneration from or limitation of liability including but not limited to the 1976 Convention.

13. FORCE MAJEURE: Company shall not be liable in any way to Passenger for death, bodily injury, illness, damage, delay or other loss or detriment to person or property or for Company's failure to commence, perform and/or complete any duty owed to Passenger if such death, delay, bodily injury (including emotional distress or injury), illness, damage or other loss or detriment to person or property is caused by Act-of-God, war or war-like operations, terrorist activities, civil commotions, labor difficulties, whether or not Company is a party thereto, interference by authorities, requisitioning of the Vessel, political disturbance, inability to secure or failure of supplies, perils of the sea, collision, foundering of the Vessel, explosion, breakdown or failure of or damage to the Vessel or its hull, machineries or fittings, weather conditions, high or low water levels, lock malfunction, that may arise or be caused by, riots, insurrection and government restraint, fire, or any other cause whatsoever beyond the reasonable control of Company.

14. CHOICE OF LAW AND FORUM: This Contract applies to claim suits and litigation of any kind whether against Company in person or the Vessel. This Contract is issued at Yangon, Myanmar. Subject always to the Athens Convention Relating to the Carriage of Passengers and their Luggage by Sea, the International Convention on Limitation of Liability For Maritime Claims, 1976, the Strasbourg Agreement on Liability Limitations for Inland Shipping of 4 November 1998 and such other international agreements and conventions as may apply, all questions arising on this Contract shall be decided according to the laws of Myanmar, excluding the rules of conflicts of laws. Where the Athens Convention or any law applies mandatorily, venue shall lie before any court sanctioned by that Convention or law. In all other cases, Company and Passenger agree to submit to the jurisdiction of the Civil Court in Yangon, Myanmar in any dispute arising out of, or in connection with, this Contract or these Terms and Conditions, the ownership and/or operation of Vessel, to the exclusion of the jurisdiction of the courts of any other country. Passenger hereby waives any venue or other objection that may be available to any such action or proceeding being brought in said court.

15. INTERPRETATION: Should any provisions of this Contract be contrary to or invalid by virtue of the law of any jurisdiction or be so held by a court of competent jurisdiction, such provision shall be deemed to be severed from this Contract and of no force and effect and all remaining provisions herein shall continue to be in full force and effect. The heading of this Contract are for convenience of reference only and shall not define or limit any of the terms or provisions hereof. Whenever the context so requires, references to the male gender shall include references to the female, and references to the singular shall include the plural and vice-versa.

16. WARRANTIES/CONSEQUENTIAL DAMAGES EXCLUDED: ALL WARRANTIES INCLUDING WARRANTIES OF FITNESS FOR USE AND MERCHANTABILITY ARE EXPRESSLY EXCLUDED FROM THIS CONTRACT. COMPANY SHALL UNDER NO CIRCUMSTANCES BE LIABLE FOR ANY INDIRECT, SPECIAL OR CONSEQUENTIAL DAMAGES.

17. WRITTEN NOTICES: **Except as otherwise expressly provided in this Contract, all written notice required by this Contract must be mailed to**

AYRAVATA CRUISES

110, 38th Street, Kyauktada Township, Yangon, Myanmar

18. ENTIRE AGREEMENT: THE PROVISIONS OF THIS TICKET/ CONTRACT REPRESENT THE ENTIRE AGREEMENT



MANAGED BY AYRAVATA CRUISE COMPANY

AND A BINDING CONTRACT BETWEEN PASSENGERS AND THE COMPANY. PASSENGER'S ACCEPTANCE OF THIS CONTRACT CONSTITUTES PASSENGER'S CONSENT TO THESE PROVISIONS. THESE PROVISIONS SUPERSEDE ANY ORAL OR WRITTEN REPRESENTATIONS. ANY CHANGE IN THESE PROVISIONS MUST BE IN WRITING AND SIGNED BY THE PRESIDENT OF COMPANY AND MAY REQUIRE A COMMENSURATE INCREASE IN FARE.



MANAGED BY AYRAVATA CRUISE COMPANY